

TOOTHAKER, JASON T  
 KURKARNAZA-TOOTHAKER, CHLOE C  
 1 SPIRO AVE  
 GRAY ME 04039

B36021P228

Previous Owner  
 KIRBY, LAURA L  
 1 SPIRO AVE

GRAY ME 04039  
 Sale Date: 9/27/2019

Previous Owner  
 HENICK, PAUL B  
 51 DUNDEE RD

WINDHAM ME 04062  
 Sale Date: 6/12/2017

Previous Owner  
 SECRETARY ODF HOUSING & URBAN DEVELOPMENT  
 2401 NW 23RD ST  
 SUITE 1A1  
 OKLAHOMA CITY OK 73107  
 Sale Date: 6/10/2016

Inspection Witnessed By:

X	Date	Description	Date Insp.

Notes:  
 5/24- DR FIELD REVIEW

Gray

Property Data		
Neighborhood	82 Average Location	
Tree Growth Year	0	
REVIEW	0	
Building Permit	0	
Zone/Land Use	12 Limited Residential	
Secondary Zone		
Topography	1 Level	
1. Well	4. Below St	7.
2. Rolling	5. Low	8.
3. Above St	6. Swampy	9.
Utilities	2 Public Water 6 Septic System	
1. Public	4. Dr. Well/Po	7. Cesspool
2. Water	5. Dug Well	8. Lake
3. Holding Ta	6. Septic	9. None
Street	1 Paved	
1. Paved	4. Proposed	8.
2. Semi Imp	5. R/O/W	9.
3. Gravel	6.	
GIS Map	15	
Field Review	1	
Sale Data		
Sale Date	9/27/2019	
Price	256,000	
Sale Type	2 Land & Buildings	
1. Land	4. Mobile	7. COM
2. L & B	5. Other	8.
3. Building	6. Condo	9.
Financing	1 Conventional	
1. Convent	4. Seller	7.
2. FHA/VA	5. Private	8.
3. Assumed	6. Cash	9. Unknown
Validity	1 Arms Length Sale	
1. Valid	4. Split	7. Multiple
2. Related	5. Partial	8. Other
3. Distress	6. Exempt	9. Estate
Verified	5 Public Record	
1. Buyer	4. Agent	7. Family
2. Seller	5. Pub Rec	8. Other
3. Lender	6. MLS	9.

Assessment Record				
Year	Land	Buildings	Exempt	Total
2011	21,000	85,290	8,500	97,790
2012	21,000	85,290	8,500	97,790
2013	21,000	87,692	8,500	100,192
2014	21,000	87,692	8,500	100,192
2015	21,000	87,700	9,000	99,700
2016	21,000	87,700	9,000	99,700
2017	21,000	87,700	0	108,700
2018	21,000	87,700	0	108,700
2019	41,000	129,300	0	170,300
2020	41,000	129,300	20,000	150,300
2021	41,000	141,400	0	182,400
2022	41,000	141,400	0	182,400
2023	41,000	161,000	0	202,000
Calc.	102,400	247,300	0	349,700

Land Data					
Type	Effective		Influence		Influence Codes
	Frontage	Depth	Factor	Code	
11. Water (0-200)			%		1. Unimproved
12. Water (201-400)			%		2. Excess Frtg
13. Water (401-800)			%		3. Topography
14. Water (801-160)			%		4. Size/Shape
15. Water (1601-32)			%		5. Access
			%		6. Restriction
			%		7. Open Space
			%		8. Environmental
			%		9. Condo
Square Foot		Square Feet		Acres	
16. Water ( 3201-			%		30. Blueberry(1-20
17. Water SF Amen			%		31. Blueberry(21 -
18. Water View			%		32. Crop Land
19. Water Influen			%		33. Pasture
20. ShoreFront A			%		34. Shorefront B
			%		35. Shorefront C
			%		36. ANTENNA SITE
			%		37. Softwood TG
			%		38. Mixed Wood TG
			%		39. Hardwood TG
			%		40. Wasteland
			%		41. Woodland
			%		42. Mobile Home Si
			%		43. Camp Site
			%		44. Lot Improvemen
			%		45. BA SF - Oce
			%		46. SP Meadow Cond
Total Acreage		0.25			

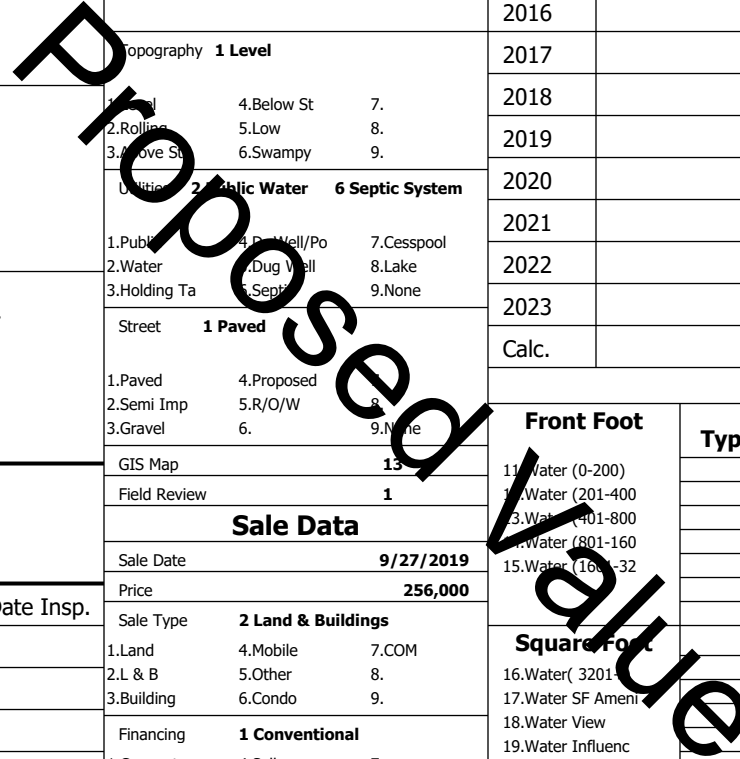

Gray

Map Lot 013-102-038-000

Account 2984

Location 1 SPIRO AVE

Card 1

Of 1

8/05/2024

Building Style <b>2 Ranch</b>	SF Bsmt Living <b>1125</b>	Layout <b>1 Typical</b>
1.Conv. 5.Garrison 9.NE farm	Fin Bsmt Grade <b>3 100</b>	1.Typical 4. 7.
2.Ranch 6.Split 10.Colonia	Secondary Heat <b>2</b>	2.Inadeq 5. 8.
3.R Ranch/ 7.Contemp 11.Cottage	Heat Type <b>100% 1 Hot Water BB</b>	3. 6. 9.
4.Cape 8.Log 12.Gambrel	1.HWBB 5.FWA 9.None	Attic <b>9 None</b>
Dwelling Units <b>1</b>	2.HWCI 6.Monitor 10.UNH2F	1.1/4 Fin 4.Full Fin 7.
Other Units <b>0</b>	3.HWRF 7.Electric 11.Geother	2.1/2 Fin 5.F/Stair 8.
Stories <b>1 One Story</b>	4.Steam 8.F/Wall 12.Heat/Co	3.3/4 Fin 6. 9.None
1.1 4.1.5 7.	Cool Type <b>0% 9 None</b>	Insulation <b>1 Full</b>
2.2 5.1.75 8.	1.Central 4.W&C Air 7.	1.Full 4.Minimal 7.
3.3 6.2.5 9.	2.Evapor 5. 8.	2.Heavy 5. 8.
Exterior Walls <b>2 Vinyl/Aluminum</b>	3.H Pump 6. 9.None	3.Capped 6. 9.None
1.Clapboard 5.Stucco 9.B & B	Kitchen Style <b>2 Typical</b>	Unfinished % <b>0%</b>
2.Vin/Al 6.Brick 10.Cemplan	1.Modern 4.Obsolete	Grade & Factor <b>3 Average 110%</b>
3.Compos./ 7.Stone 11.Concret	2.Typical 5. 8.	1.E Grade 4.B Grade 7.SC Grade
4.Asbestos 8.Wood Shi 12.Wood Bo	3.Old Type 6. 9.None	2.O Grade 5.A Grade 8.
Roof Surface <b>3 Metal</b>	Bath(s) Style <b>2 Typical Bath(s)</b>	3.O Grade 6.AA Grade 9.Same
1.Asphalt 4.Composit 7.Other	1.Modern 4.Obsolete 7.	SQFT (Footprint) <b>1125</b>
2.Slate 5.Wood 8.	2.Typical 5. 8.	Condition <b>5 Good</b>
3.Metal 6.Roll Roo 9.	3.Old Type 6. 9.None	1.Poor 4.Avg 7.V G
SF Masonry Trim <b>0</b>	# Rooms <b>7</b>	2.Fair 3.Avg 8.Exc
SOLAR VOLTAIC <b>0</b>	# Bedrooms <b>3</b>	3.Avg- 9.Same
OPEN-4- <b>0</b>	# Full Baths <b>1</b>	Phys. % Good <b>0%</b>
Year Built <b>1980</b>	# Half Baths <b>0</b>	Funct. % Good <b>100%</b>
Year Remodeled <b>2013</b>	# Addn Fixtures <b>0</b>	Functional Code <b>9 None</b>
Foundation <b>1 Concrete</b>	# Fireplaces <b>0</b>	1.Incomp 4.Delap 9.Layo
1.Concrete 4.Wood 7.		2.O-Built 5.Bsmt 8.Long term
2.C Block 5.Slab 8.		3.Damage 6.Style 9.None
3.Br/Stone 6.Piers 9.		Econ. % Good <b>100%</b>
Basement <b>4 Full Basement</b>		Economic Code <b>None</b>
1.1/4 Bmt 4.Full Bmt 7.		0.None 3.No Power 6.Obsolete
2.1/2 Bmt 5.Crw 8.		1.Location 4.Generate 9.None
3.3/4 Bmt 6. 9.None		2.Encroach 5.Flood Pl 9.
Bsmt Gar # Cars <b>0</b>		Entrance Code <b>5 Estimated</b>
Wet Basement <b>1 Dry Basement</b>		1.Interior 4.Vacant 7.
1.Dry 4. 7.		2.Refusal 5.Estimate 8.
2.Damp 5. 8.	3.Informed 6. 9.	
3.Wet 6. 9.	Information Code <b>5 Estimate</b>	
	1.Owner 4.Agent 7.	
	2.Relative 5.Estimate 8.	
	3.Tenant 6.Other 9.	

Date Inspected 5/16/2024

**Additions, Outbuildings & Improvements**

Type	Year	Units	Grade	Cond	Phys.	Funct.	Sound Value
22 Encl Frame Porch	0	80	0 0	0	0	% 100 %	1.One Story Fram
62 Patio	0	120	0 0	0	0	% 100 %	2.Two Story Fram
24 Frame Shed	2022	176	0 0	0	0	% 100 %	3.Three Story Fr
						% %	4.1 & 1/2 Story
						% %	5.1 & 3/4 Story
						% %	6.2 & 1/2 Story
						% %	21.Open Frame Por
						% %	22.Encl Frame Por
						% %	23.Frame Garage
						% %	24.Frame Shed
						% %	25.Frame Bay Wind
						% %	26.1SFr Overhang
						% %	27.Unfin Basement
						% %	28.Unfinished Att
						% %	29.Finished Attic

