

WHITNEY, DAVID P
WHITNEY, MIA C
22 PINE COVE RD
GRAY ME 04039

B12657P258

Inspection Witnessed By:

No./Date	Description	Date Insp.
X		

Notes:

Gray

Property Data			Assessment Record						
Neighborhood 2 Crystal Lake 1			Year	Land	Buildings	Exempt	Total		
Tree Growth Year 0			2011	130,260	85,280	8,500	207,040		
REVIEW 0			2012	130,260	85,280	8,500	207,040		
Building Permit 0			2013	130,260	85,280	8,500	207,040		
Zone/Land Use 12 Limited Residential			2014	130,260	87,269	8,500	209,029		
Secondary Zone			2015	130,300	87,300	9,000	208,600		
Topography 1 Level			2016	130,300	87,300	9,000	208,600		
1. Level 4. Below St 7.			2017	130,300	86,900	13,500	203,700		
2. Rolling 5. Low 8.			2018	130,300	86,900	18,000	199,200		
3. Above St 6. Swampy 9.			2019	124,200	121,600	20,000	225,800		
Utilities 2 Public Water 6 Septic System			2020	124,200	121,600	20,000	225,800		
1. Public 4. Dr. Well/Po 7. Cesspool			2021	124,200	121,600	25,000	220,800		
2. Water 5. Dug Well 8. Lake			2022	124,200	121,600	25,000	220,800		
3. Holding Ta 6. Septic 9. None			2023	124,200	144,100	25,000	243,300		
Street 3 Gravel			Calc.	264,700	197,200	25,000	436,900		
1. Paved 4. Proposed			Land Data						
2. Semi Imp 5. R/O/W			Front Foot	Type	Effective		Influence		Influence Codes
3. Gravel 6. None 9. None			11. Water (0-200)	11	Frontage	Depth	Factor	Code	
GIS Map 13			12. Water (201-400)				100 %	0	1. Unimproved
Field Review 1			13. Water (401-800)				%		2. Excess Frtg
Sale Data			14. Water (801-160)				%		3. Topography
Sale Date 8/09/1996			15. Water (161-32)				%		4. Size/Shape
Price			16. Water (3201-)				%		5. Access
Sale Type			17. Water SF Amen				%		6. Restriction
1. Land 4. Mobile 7. COM			18. Water View				%		7. Open Space
2. L & B 5. Other 8.			19. Water Influen				%		8. Environmental
3. Building 6. Condo 9.			20. ShoreFront A				%		9. Condo
Financing			Square Foot	Square Feet			%		Acres
1. Convent 4. Seller 7.			21. Base Lot	20		0.34	100 %	0	30. Blueberry(1-20
2. FHA/VA 5. Private 8.			22. Base Lot Vacan				%		31. Blueberry(21 -
3. Assumed 6. Cash 9. Unknown			23. Base Lot Unpav				%		32. Crop Land
Validity			Acres				%		33. Pasture
1. Valid 4. Split 7. Multiple			24. Acres to 10				%		34. Shorefront B
2. Related 5. Partial 8. Other			25. Acres 11-30				%		35. Shorefront C
3. Distress 6. Exempt 9. Estate			26. Acres 31-50				%		36. ANTENNA SITE
Verified			27. Acres 51& over				%		37. Softwood TG
1. Buyer 4. Agent 7. Family			28. Acres 71 & Ove				%		38. Mixed Wood TG
2. Seller 5. Pub Rec 8. Other			29. Woods (41+)				%		39. Hardwood TG
3. Lender 6. MLS 9.			Total Acreage		0.34				40. Wasteland
									41. Woodland
									42. Mobile Home Si
									43. Camp Site
									44. Lot Improvemen
									45. BA SF - Oce
									46. SP Meadow Cond

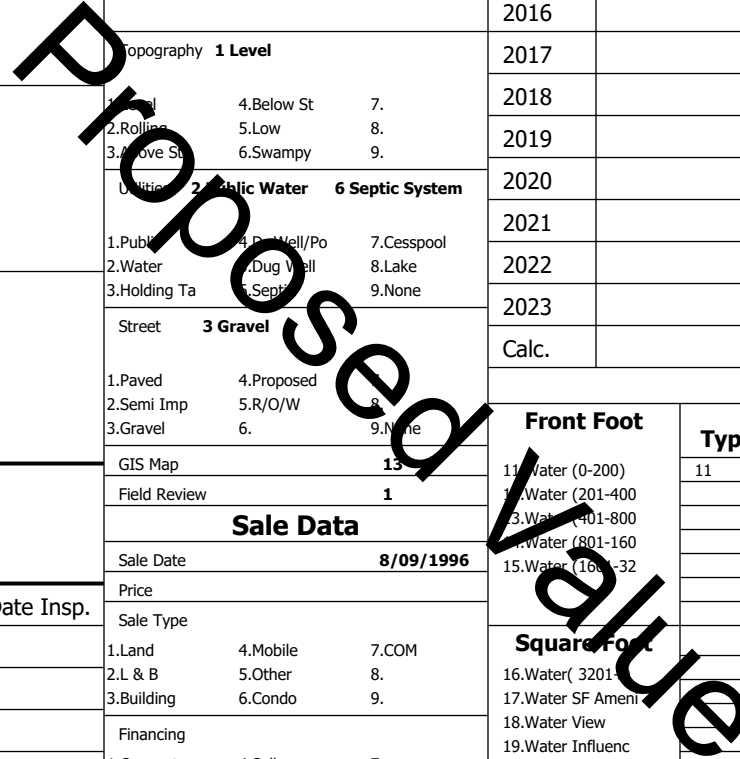

Gray

Map Lot 013-102-021-000

Account 2968

Location 22 PINE COVE RD

Card 1

Of 1

8/05/2024

Building Style 1 Conventional	SF Bsmt Living 200	Layout 1 Typical
1.Conv. 5.Garrison 9.NE farm	Fin Bsmt Grade 3 100	1.Typical 4. 7.
2.Ranch 6.Split 10.Colonia	Secondary Heat 0	2.Inadeq 5. 8.
3.R Ranch/ 7.Contemp 11.Cottage	Heat Type 100% 5 Forced Warm Air	3. 6. 9.
4.Cape 8.Log 12.Gambrel	1.HWBB 5.FWA 9.None	Attic 9 None
Dwelling Units 1	2.HWCI 6.Monitor 10.UNH2F	1.1/4 Fin 4.Full Fin 7.
Other Units 0	3.HWRF 7.Electric 11.Geother	2.1/2 Fin 5.FI/Stair 8.
Stories 2 Two Story	4.Steam 8.FI/Wall 12.Heat/Co	3.3/4 Fin 6. 9.None
1.1 4.1.5 7.	Cool Type 0% 9 None	Insulation 1 Full
2.2 5.1.75 8.	1.Central 4.W&C Air 7.	1.Full 4.Minimal 7.
3.3 6.2.5 9.	2.Evapor 5. 8.	2.Heavy 5. 8.
Exterior Walls 1 Clapboard	3.H Pump 6. 9.None	3.Capped 6. 9.None
1.Clapboar 5.Stucco 9.B & B	Kitchen Style 2 Typical	Unfinished % 0%
2.Vin/Al 6.Brick 10.Cemplan	1.Modern 4.Obsolete	Grade & Factor 3 Average 100%
3.Compos./ 7.Stone 11.Concret	2.Typical 5. 8.	1.E Grade 4.B Grade 7.SC Grade
4.Asbestos 8.Wood Shi 12.Wood Bo	3.Old Type 6. 9.None	2.D Grade 5.A Grade 8.
Roof Surface 3 Metal	Bath(s) Style 2 Typical Bath(s)	3.Grade 6.AA Grade 9.Same
1.Asphalt 4.Composit 7.Other	1.Modern 4.Obsolete 7.	SQFT (Footprint) 720
2.Slate 5.Wood 8.	2.Typical 5. 8.	Condition 4 Average
3.Metal 6.Roll Roo 9.	3.Old Type 6. 9.None	1.Poor Avg 7.V G
SF Masonry Trim 0	# Rooms 5	2.Fair Avg 8.Exc
SOLAR VOLTAIC 0	# Bedrooms 3	3.Avg- Good 9.Same
OPEN-4- 0	# Full Baths 2	Phys. % Good 0%
Year Built 1950	# Half Baths 0	Funct. % Good 100%
Year Remodeled 1997	# Addn Fixtures 0	Functional Code 9 None
Foundation 1 Concrete	# Fireplaces 0	1.Incomp 4.Delap 9.Layoff
1.Concrete 4.Wood 7.		2.O-Built 5.Bsmt 8.Long term
2.C Block 5.Slab 8.		3.Damage 6.Style 9.None
3.Br/Stone 6.Piers 9.		Econ. % Good 100%
Basement 4 Full Basement		Economic Code None
1.1/4 Bmt 4.Full Bmt 7.		0.None 3.No Power 6.Obsolete
2.1/2 Bmt 5.Crwl 8.		1.Location 4.Generate 9.None
3.3/4 Bmt 6. 9.None		2.Encroach 5.Flood Pl 9.
Bsmt Gar # Cars 0		Entrance Code 5 Estimated
Wet Basement 1 Dry Basement		1.Interior 4.Vacant 7.
1.Dry 4. 7.		2.Refusal 5.Estimate 8.
2.Damp 5. 8.		3.Informed 6. 9.
3.Wet 6. 9.		Information Code 5 Estimate
		1.Owner 4.Agent 7.
		2.Relative 5.Estimate 8.
		3.Tenant 6.Other 9.

Date Inspected 7/28/2015

Additions, Outbuildings & Improvements

Type	Year	Units	Grade	Cond	Phys.	Funct.	Sound Value
21 Open Frame	0	192	0 0	0	0 %	100 %	1.One Story Fram
68 Wood Deck	0	36	0 0	0	0 %	100 %	2.Two Story Fram
24 Frame Shed	0	180	3 100	4	0 %	100 %	3.Three Story Fr
					%	%	4.1 & 1/2 Story
					%	%	5.1 & 3/4 Story
					%	%	6.2 & 1/2 Story
					%	%	21.Open Frame Por
					%	%	22.Encl Frame Por
					%	%	23.Frame Garage
					%	%	24.Frame Shed
					%	%	25.Frame Bay Wind
					%	%	26.1SFr Overhang
					%	%	27.Unfin Basement
					%	%	28.Unfinished Att
					%	%	29.Finished Attic

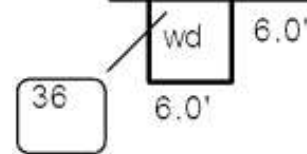
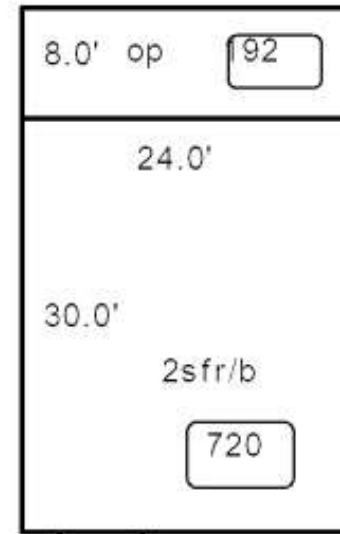

Proposed

Valerie