

MAINS, WILLIAM J
3 OUTBACK LANE
GRAY ME 04039

B13355P125

Inspection Witnessed By:

No./Date	Description	Date Insp.
X		

Notes:

Gray

Property Data			Assessment Record				
Neighborhood	82 Average Location		Year	Land	Buildings	Exempt	Total
Tree Growth Year	0		2011	53,500	102,128	0	155,628
REVIEW	0		2012	53,500	102,128	0	155,628
Building Permit	0		2013	53,500	102,128	0	155,628
Zone/Land Use	11 Rural Residential & Agri		2014	53,500	102,128	0	155,628
Secondary Zone	14 Limited Comm		2015	53,500	102,100	0	155,600
Topography	1 Level		2016	53,500	102,100	0	155,600
1. Hill	4. Below St	7.	2017	53,500	105,500	0	159,000
2. Rolling	5. Low	8.	2018	53,500	105,500	0	159,000
3. Above St	6. Swampy	9.	2019	75,000	171,200	0	246,200
Utilities	4. Filled Well/Point 6 Septic System		2020	75,000	171,200	0	246,200
1. Public	4. Driv Well/Po	7. Cesspool	2021	75,000	171,200	0	246,200
2. Water	5. Dug Well	8. Lake	2022	75,000	171,200	0	246,200
3. Holding Ta	6. Septic	9. None	2023	75,000	192,500	0	267,500
Street	3 Gravel		Calc.	160,000	267,100	0	427,100
1. Paved	4. Proposed	8.	Land Data				
2. Semi Imp	5. R/O/W	9.	Front Foot	Type	Effective	Influence	Influence
3. Gravel	6.	9. None	11. Water (0-200)		Frontage	Depth	Factor
GIS Map	19		12. Water (201-400)				Code
Field Review	0		13. Water (401-800)				1. Unimproved
Sale Data			14. Water (801-160)				2. Excess Frtg
Sale Date			15. Water (161-32)				3. Topography
Price			Square Foot				4. Size/Shape
Sale Type			16. Water (3201-)				5. Access
1. Land	4. Mobile	7. COM	17. Water SF Amen				6. Restriction
2. L & B	5. Other	8.	18. Water View				7. Open Space
3. Building	6. Condo	9.	19. Water Influen				8. Environmental
Financing			20. ShoreFront A				9. Condo
1. Convent	4. Seller	7.	Fract. Acre				Acres
2. FHA/VA	5. Private	8.	21. Base Lot				30. Blueberry(1-20
3. Assumed	6. Cash	9. Unknown	22. Base Lot Vacan				31. Blueberry(21 -
Validity			23. Base Lot Unpav				32. Crop Land
1. Valid	4. Split	7. Multiple	Acres				33. Pasture
2. Related	5. Partial	8. Other	24. Acres to 10				34. Shorefront B
3. Distress	6. Exempt	9. Estate	25. Acres 11-30				35. Shorefront C
Verified			26. Acres 31-50				36. ANTENNA SITE
1. Buyer	4. Agent	7. Family	27. Acres 51& over				37. Softwood TG
2. Seller	5. Pub Rec	8. Other	28. Acres 71 & Ove				38. Mixed Wood TG
3. Lender	6. MLS	9.	29. Woods (41+)				39. Hardwood TG
			Total Acreage		8.50		40. Wasteland
							41. Woodland
							42. Mobile Home Si
							43. Camp Site
							44. Lot Improvemen
							45. BA SF - Oce
							46. SP Meadow Cond

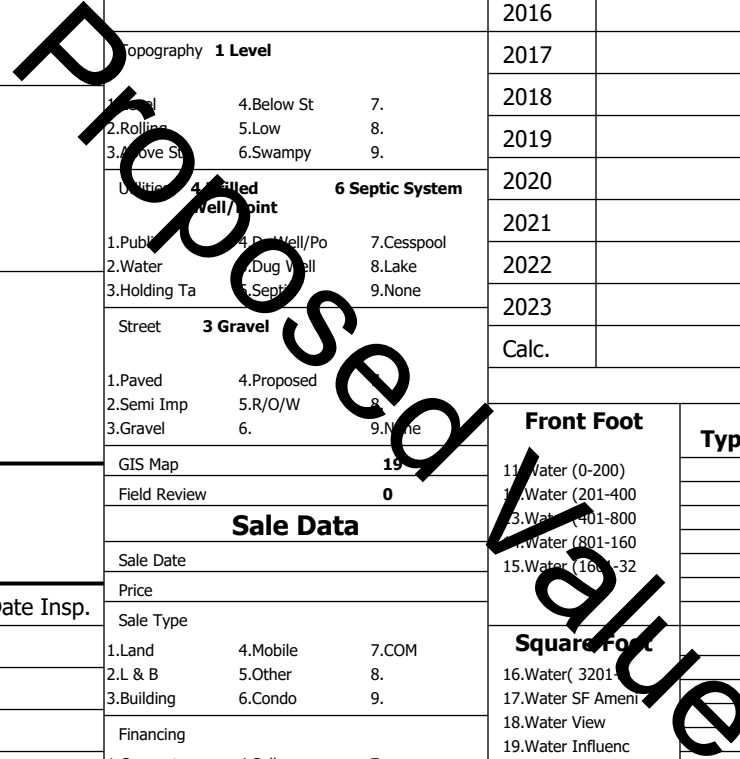

Gray

Map Lot 013-015-019-000

Account 620

Location 3 OUTBACK LN

Card 1

Of 1

8/05/2024

Building Style 2 Ranch	SF Bsmt Living 0	Layout 1 Typical
1.Conv. 5.Garrison 9.NE farm	Fin Bsmt Grade 0 0	1.Typical 4. 7.
2.Ranch 6.Split 10.Colonia	Secondary Heat 0	2.Inadeq 5. 8.
3.R Ranch/ 7.Contemp 11.Cottage	Heat Type 100% 1 Hot Water BB	3. 6. 9.
4.Cape 8.Log 12.Gambrel	1.HWBB 5.FWA 9.None	Attic 9 None
Dwelling Units 1	2.HWCI 6.Monitor 10.UNH2F	1.1/4 Fin 4.Full Fin 7.
Other Units 0	3.HWRF 7.Electric 11.Geother	2.1/2 Fin 5.FI/Stair 8.
Stories 1 One Story	4.Steam 8.FI/Wall 12.Heat/Co	3.3/4 Fin 6. 9.None
1.1 4.1.5 7.	Cool Type 0% 9 None	Insulation 1 Full
2.2 5.1.75 8.	1.Central 4.W&C Air 7.	1.Full 4.Minimal 7.
3.3 6.2.5 9.	2.Evapor 5. 8.	2.Heavy 5. 8.
Exterior Walls 8 Wood Shingle	3.H Pump 6. 9.None	3.Capped 6. 9.None
1.Clapboar 5.Stucco 9.B & B	Kitchen Style 2 Typical	Unfinished % 0%
2.Vin/Al 6.Brick 10.Cemplan	1.Modern 4.Obsolete	Grade & Factor 3 Average 110%
3.Compos./ 7.Stone 11.Concret	2.Typical 5. 8.	1.E Grade 4.B Grade 7.SC Grade
4.Asbestos 8.Wood Shi 12.Wood Bo	3.Old Type 6. 9.None	2.D Grade 5.A Grade 8.
Roof Surface 1 Asphalt Shingles	Bath(s) Style 2 Typical Bath(s)	3.C Grade 6.AA Grade 9.Same
1.Asphalt 4.Composit 7.Other	1.Modern 4.Obsolete 7.	SQFT (Footprint) 1326
2.Slate 5.Wood 8.	2.Typical 5. 8.	Condition 5 Above Average
3.Metal 6.Roll Roo 9.	3.Old Type 6. 9.None	1.Poor Avg 7.V G
SF Masonry Trim 0	# Rooms 5	2.Fair Avg 8.Exc
SOLAR VOLTAIC 0	# Bedrooms 2	3.Avg- Good 9.Same
OPEN-4- 0	# Full Baths 2	Phys. % Good 0%
Year Built 1988	# Half Baths 1	Funct. % Good 100%
Year Remodeled 0	# Addn Fixtures 0	Functional Code 9 None
Foundation 1 Concrete	# Fireplaces 0	1.Incomp 4.Delap 5.Playoff
1.Concrete 4.Wood 7.		2.O-Built 5.Bsmt 8.Long term
2.C Block 5.Slab 8.		3.Damage 6.Style 9.None
3.Br/Stone 6.Piers 9.		Econ. % Good 100%
Basement 4 Full Basement		Economic Code None
1.1/4 Bmt 4.Full Bmt 7.		0.None 3.No Power 6.Obsolete
2.1/2 Bmt 5.Crwl 8.		1.Location 4.Generate 9.None
3.3/4 Bmt 6. 9.None		2.Encroach 5.Flood Pl 9.
Bsmt Gar # Cars 0		Entrance Code 1 Interior Inspect
Wet Basement 1 Dry Basement		1.Interior 4.Vacant 7.
1.Dry 4. 7.		2.Refusal 5.Estimate 8.
2.Damp 5. 8.	3.Informed 6. 9.	
3.Wet 6. 9.	Information Code 1 Owner	
	1.Owner 4.Agent 7.	
	2.Relative 5.Estimate 8.	
	3.Tenant 6.Other 9.	

Date Inspected 7/31/2015

Additions, Outbuildings & Improvements

Type	Year	Units	Grade	Cond	Phys.	Funct.	Sound Value
21 Open Frame	0	78	0 0	0	0 %	100 %	
68 Wood Deck	2000	357	3 100	4	0 %	100 %	1.One Story Fram
24 Frame Shed	2007	384	3 100	4	0 %	100 %	2.Two Story Fram
24 Frame Shed	2010	308	3 100	4	0 %	100 %	3.Three Story Fr
24 Frame Shed	1995	120	3 100	4	0 %	100 %	4.1 & 1/2 Story
					%	%	5.1 & 3/4 Story
					%	%	6.2 & 1/2 Story
					%	%	21.Open Frame Por
					%	%	22.Encl Frame Por
					%	%	23.Frame Garage
					%	%	24.Frame Shed
					%	%	25.Frame Bay Wind
					%	%	26.1SFr Overhang
					%	%	27.Unfin Basement
					%	%	28.Unfinished Att
					%	%	29.Finished Attic

