

LIBFAM, LLC
15 SHAKER ROAD
GRAY ME 04039

B30271P191

Inspection Witnessed By:

No./Date	Description	Date Insp.
X		

Notes:
5/24- DR FIELD REVIEW. PAPER ROAD

Gray

Property Data			Assessment Record																																																																																																																																																																																				
Neighborhood 81 Fair-Traffic			Year	Land	Buildings	Exempt	Total																																																																																																																																																																																
Tree Growth Year 0			2011	20,300	0	0	20,300																																																																																																																																																																																
REVIEW 0			2012	20,300	0	0	20,300																																																																																																																																																																																
Building Permit 0			2013	20,300	0	0	20,300																																																																																																																																																																																
Zone/Land Use 11 Rural Residential & Agri			2014	20,300	0	0	20,300																																																																																																																																																																																
Secondary Zone			2015	20,300	0	0	20,300																																																																																																																																																																																
Topography 1 Level			2016	20,300	0	0	20,300																																																																																																																																																																																
1. Level 4. Below St 7.			2017	20,300	0	0	20,300																																																																																																																																																																																
2. Rolling 5. Low 8.			2018	20,300	0	0	20,300																																																																																																																																																																																
3. Above St 6. Swampy 9.			2019	19,900	0	0	19,900																																																																																																																																																																																
Utilities			2020	19,900	0	0	19,900																																																																																																																																																																																
1. Public 4. Driv Well/Po 7. Cesspool			2021	19,900	0	0	19,900																																																																																																																																																																																
2. Water 5. Dug Well 8. Lake			2022	19,900	0	0	19,900																																																																																																																																																																																
3. Holding Ta 6. Septic 9. None			2023	22,100	0	0	22,100																																																																																																																																																																																
Street 3 Gravel			Calc.	45,200	0	0	45,200																																																																																																																																																																																
1. Paved 4. Proposed			<table border="1"> <thead> <tr> <th colspan="4">Land Data</th> </tr> <tr> <th rowspan="2">Type</th> <th colspan="2">Effective</th> <th colspan="2">Influence</th> <th rowspan="2">Influence Codes</th> </tr> <tr> <th>Frontage</th> <th>Depth</th> <th>Factor</th> <th>Code</th> </tr> </thead> <tbody> <tr> <td>11. Water (0-200)</td> <td></td> <td></td> <td>%</td> <td></td> <td>1. Unimproved</td> </tr> <tr> <td>12. Water (201-400)</td> <td></td> <td></td> <td>%</td> <td></td> <td>2. Excess Frtg</td> </tr> <tr> <td>13. Water (401-800)</td> <td></td> <td></td> <td>%</td> <td></td> <td>3. Topography</td> </tr> <tr> <td>14. Water (801-1600)</td> <td></td> <td></td> <td>%</td> <td></td> <td>4. Size/Shape</td> </tr> <tr> <td>15. Water (1601-3200)</td> <td></td> <td></td> <td>%</td> <td></td> <td>5. Access</td> </tr> <tr> <td></td> <td></td> <td></td> <td>%</td> <td></td> <td>6. Restriction</td> </tr> <tr> <td></td> <td></td> <td></td> <td>%</td> <td></td> <td>7. Open Space</td> </tr> <tr> <td></td> <td></td> <td></td> <td>%</td> <td></td> <td>8. Environmental</td> </tr> <tr> <td></td> <td></td> <td></td> <td>%</td> <td></td> <td>9. Condo</td> </tr> <tr> <td></td> <td></td> <td></td> <td>%</td> <td></td> <td>Acres</td> </tr> <tr> <td></td> <td></td> <td></td> <td>%</td> <td></td> <td>30. Blueberry(1-20</td> </tr> <tr> <td></td> <td></td> <td></td> <td>%</td> <td></td> <td>31. Blueberry(21 -</td> </tr> <tr> <td></td> <td></td> <td></td> <td>%</td> <td></td> <td>32. Crop Land</td> </tr> <tr> <td></td> <td></td> <td></td> <td>%</td> <td></td> <td>33. Pasture</td> </tr> <tr> <td></td> <td></td> <td></td> <td>%</td> <td></td> <td>34. Shorefront B</td> </tr> <tr> <td></td> <td></td> <td></td> <td>%</td> <td></td> <td>35. Shorefront C</td> </tr> <tr> <td></td> <td></td> <td></td> <td>%</td> <td></td> <td>36. ANTENNA SITE</td> </tr> <tr> <td></td> <td></td> <td></td> <td>%</td> <td></td> <td>37. Softwood TG</td> </tr> <tr> <td></td> <td></td> <td></td> <td>%</td> <td></td> <td>38. Mixed Wood TG</td> </tr> <tr> <td></td> <td></td> <td></td> <td>%</td> <td></td> <td>39. Hardwood TG</td> </tr> <tr> <td></td> <td></td> <td></td> <td>%</td> <td></td> <td>40. Wasteland</td> </tr> <tr> <td></td> <td></td> <td></td> <td>%</td> <td></td> <td>41. Woodland</td> </tr> <tr> <td></td> <td></td> <td></td> <td>%</td> <td></td> <td>42. Mobile Home Si</td> </tr> <tr> <td></td> <td></td> <td></td> <td>%</td> <td></td> <td>43. Camp Site</td> </tr> <tr> <td></td> <td></td> <td></td> <td>%</td> <td></td> <td>44. Lot Improvemen</td> </tr> <tr> <td></td> <td></td> <td></td> <td>%</td> <td></td> <td>45. BA SF - Oce</td> </tr> <tr> <td></td> <td></td> <td></td> <td>%</td> <td></td> <td>46. SP Meadow Cond</td> </tr> </tbody> </table>					Land Data				Type	Effective		Influence		Influence Codes	Frontage	Depth	Factor	Code	11. Water (0-200)			%		1. Unimproved	12. Water (201-400)			%		2. Excess Frtg	13. Water (401-800)			%		3. Topography	14. Water (801-1600)			%		4. Size/Shape	15. Water (1601-3200)			%		5. Access				%		6. Restriction				%		7. Open Space				%		8. Environmental				%		9. Condo				%		Acres				%		30. Blueberry(1-20				%		31. Blueberry(21 -				%		32. Crop Land				%		33. Pasture				%		34. Shorefront B				%		35. Shorefront C				%		36. ANTENNA SITE				%		37. Softwood TG				%		38. Mixed Wood TG				%		39. Hardwood TG				%		40. Wasteland				%		41. Woodland				%		42. Mobile Home Si				%		43. Camp Site				%		44. Lot Improvemen				%		45. BA SF - Oce				%		46. SP Meadow Cond
Land Data																																																																																																																																																																																							
Type	Effective							Influence		Influence Codes																																																																																																																																																																													
	Frontage	Depth	Factor	Code																																																																																																																																																																																			
11. Water (0-200)			%		1. Unimproved																																																																																																																																																																																		
12. Water (201-400)			%		2. Excess Frtg																																																																																																																																																																																		
13. Water (401-800)			%		3. Topography																																																																																																																																																																																		
14. Water (801-1600)			%		4. Size/Shape																																																																																																																																																																																		
15. Water (1601-3200)			%		5. Access																																																																																																																																																																																		
			%		6. Restriction																																																																																																																																																																																		
			%		7. Open Space																																																																																																																																																																																		
			%		8. Environmental																																																																																																																																																																																		
			%		9. Condo																																																																																																																																																																																		
			%		Acres																																																																																																																																																																																		
			%		30. Blueberry(1-20																																																																																																																																																																																		
			%		31. Blueberry(21 -																																																																																																																																																																																		
			%		32. Crop Land																																																																																																																																																																																		
			%		33. Pasture																																																																																																																																																																																		
			%		34. Shorefront B																																																																																																																																																																																		
			%		35. Shorefront C																																																																																																																																																																																		
			%		36. ANTENNA SITE																																																																																																																																																																																		
			%		37. Softwood TG																																																																																																																																																																																		
			%		38. Mixed Wood TG																																																																																																																																																																																		
			%		39. Hardwood TG																																																																																																																																																																																		
			%		40. Wasteland																																																																																																																																																																																		
			%		41. Woodland																																																																																																																																																																																		
			%		42. Mobile Home Si																																																																																																																																																																																		
			%		43. Camp Site																																																																																																																																																																																		
			%		44. Lot Improvemen																																																																																																																																																																																		
			%		45. BA SF - Oce																																																																																																																																																																																		
			%		46. SP Meadow Cond																																																																																																																																																																																		
GIS Map 0			Front Foot																																																																																																																																																																																				
Field Review 1			Square Foot																																																																																																																																																																																				
Sale Date 12/31/2012			Fract. Acre																																																																																																																																																																																				
Price			Acres																																																																																																																																																																																				
Sale Type			Verified																																																																																																																																																																																				
1. Land 4. Mobile 7.COM			1. Buyer 4. Agent 7. Family																																																																																																																																																																																				
2. L & B 5. Other 8.			2. Seller 5. Pub Rec 8. Other																																																																																																																																																																																				
3. Building 6. Condo 9.			3. Lender 6. MLS 9.																																																																																																																																																																																				
Financing			Validity																																																																																																																																																																																				
1. Convent 4. Seller 7.			1. Valid 4. Split 7. Multiple																																																																																																																																																																																				
2. FHA/VA 5. Private 8.			2. Related 5. Partial 8. Other																																																																																																																																																																																				
3. Assumed 6. Cash 9. Unknown			3. Distress 6. Exempt 9. Estate																																																																																																																																																																																				

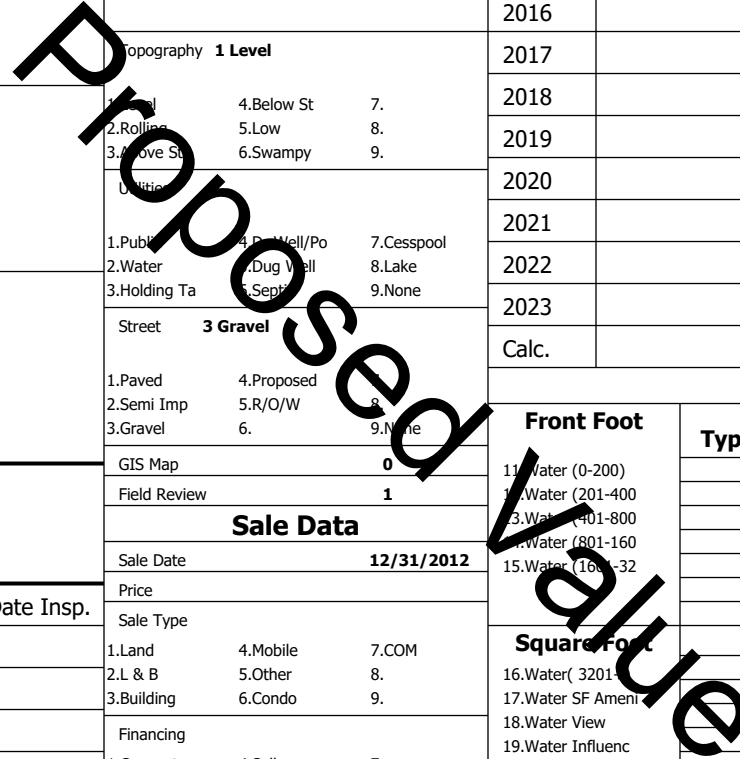

Gray

Map Lot 013-010-001-012

Account 4562

Location FREEDOM DR

Card 1

Of 1

8/05/2024

Building Style 0	SF Bsmt Living 0	Layout 0
1.Conv. 5.Garrison 9.NE farm	Fin Bsmt Grade 0 0	1.Typical 4. 7.
2.Ranch 6.Split 10.Colonia	Secondary Heat 0	2.Inadeq 5. 8.
3.R Ranch/ 7.Contemp 11.Cottage	Heat Type 100% 0	3. 6. 9.
4.Cape 8.Log 12.Gambrel	1.HWBB 5.FWA 9.None	Attic 0
Dwelling Units 0	2.HWCI 6.Monitor 10.UNH2F	1.1/4 Fin 4.Full Fin 7.
Other Units 0	3.HWRF 7.Electric 11.Geother	2.1/2 Fin 5.FI/Stair 8.
Stories 0	4.Steam 8.FI/Wall 12.Heat/Co	3.3/4 Fin 6. 9.None
1.1 4.1.5 7.	Cool Type 0% 9 None	Insulation 0
2.2 5.1.75 8.	1.Central 4.W&C Air 7.	1.Full 4.Minimal 7.
3.3 6.2.5 9.	2.Evapor 5. 8.	2.Heavy 5. 8.
Exterior Walls 0	3.H Pump 6. 9.None	3.Capped 6. 9.None
1.Clapboar 5.Stucco 9.B & B	Kitchen Style 0	Unfinished % 0%
2.Vin/Al 6.Brick 10.Cemplan	1.Modern 4.Obsolete	Grade & Factor 0 0%
3.Compos./ 7.Stone 11.Concret	2.Typical 5. 8.	1.E Grade 4.B Grade 7.SC Grade
4.Asbestos 8.Wood Shi 12.Wood Bo	3.Old Type 6. 9.None	2.C Grade 5.A Grade 8.
Roof Surface 0	Bath(s) Style 0	3.D Grade 6.AA Grade 9.Same
1.Asphalt 4.Composit 7.Other	1.Modern 4.Obsolete 7.	SQFT (Footprint) 0
2.Slate 5.Wood 8.	2.Typical 5. 8.	1.Poor Avg 7.V G
3.Metal 6.Roll Roo 9.	3.Old Type 6. 9.None	2.Fair Avg 8.Exc
SF Masonry Trim 0	# Rooms 0	3.Avg- Good 9.Same
SOLAR VOLTAIC 0	# Bedrooms 0	Phys. % Good 0%
OPEN-4- 0	# Full Baths 0	Funct. % Good 100%
Year Built 0	# Half Baths 0	Functional Code 9 None
Year Remodeled 0	# Addn Fixtures 0	1.Incomp 4.Delap 9.Layoff
Foundation 0	# Fireplaces 0	2.O-Built 5.Bsmt 8.Long term
1.Concrete 4.Wood 7.		3.Damage 6.Style None
2.C Block 5.Slab 8.		Econ. % Good 100%
3.Br/Stone 6.Piers 9.		Economic Code None
Basement 0		0.None 3.No Power 6.Obsolete
1.1/4 Bmt 4.Full Bmt 7.		1.Location 4.Generate 9.None
2.1/2 Bmt 5.Crwl 8.		2.Encroach 5.Flood Pl 9.
3.3/4 Bmt 6. 9.None		Entrance Code 5 Estimated
Bsmt Gar # Cars 0		1.Interior 4.Vacant 7.
Wet Basement 0		2.Refusal 5.Estimate 8.
1.Dry 4. 7.		3.Informed 6. 9.
2.Damp 5. 8.	Information Code 5 Estimate	
3.Wet 6. 9.	1.Owner 4.Agent 7.	
	2.Relative 5.Estimate 8.	
	3.Tenant 6.Other 9.	

Date Inspected 5/09/2024

Additions, Outbuildings & Improvements

Type	Year	Units	Grade	Cond	Phys.	Funct.	Sound Value
					%	%	1.One Story Fram
					%	%	2.Two Story Fram
					%	%	3.Three Story Fr
					%	%	4.1 & 1/2 Story
					%	%	5.1 & 3/4 Story
					%	%	6.2 & 1/2 Story
					%	%	21.Open Frame Por
					%	%	22.Encl Frame Por
					%	%	23.Frame Garage
					%	%	24.Frame Shed
					%	%	25.Frame Bay Wind
					%	%	26.1SFr Overhang
					%	%	27.Unfin Basement
					%	%	28.Unfinished Att
					%	%	29.Finished Attic

Proposed Value