

STAYTE, SHAUN R
55 MAY MEADOW ROAD
GRAY ME 04039

B35691P317

Previous Owner
LARGAY, THOMAS F, JR
LARGAY, ANNA F
55 MAY MEADOW DR
GRAY ME 04039
Sale Date: 6/04/2019

Property Data			Assessment Record				
Neighborhood	83 Avg-Good Location		Year	Land	Buildings	Exempt	Total
Tree Growth Year	0		2011	61,000	186,594	0	247,594
REVIEW	0		2012	61,000	186,594	0	247,594
Building Permit	0		2013	61,000	186,594	0	247,594
Zone/Land Use	11 Rural Residential & Agri		2014	61,000	186,594	0	247,594
Secondary Zone			2015	61,000	186,600	0	247,600
Topography	1 Level		2016	61,000	186,600	9,000	238,600
			2017	61,000	188,900	13,500	236,400
			2018	61,000	188,900	18,000	231,900
			2019	68,900	273,600	20,000	322,500
			2020	68,900	273,600	20,000	322,500
			2021	68,900	273,600	0	342,500
			2022	68,900	287,700	0	356,600
			2023	68,900	319,600	0	388,500
			Calc.	133,300	487,500	25,000	595,800

Land Data		Front Foot		Effective		Influence		Influence Codes	
Type		Frontage	Depth	Factor	Code				
1. Water (0-200)				%				1. Unimproved	
2. Water (201-400)				%				2. Excess Frtg	
3. Water (401-800)				%				3. Topography	
4. Water (801-1600)				%				4. Size/Shape	
5. Water (1601-3200)				%				5. Access	
				%				6. Restriction	
				%				7. Open Space	
				%				8. Environmental	
				%				9. Condo	
				%				30. Blueberry(1-20	
				%				31. Blueberry(21 -	
				%				32. Crop Land	
				%				33. Pasture	
				%				34. Shorefront B	
				%				35. Shorefront C	
				%				36. ANTENNA SITE	
				%				37. Softwood TG	
				%				38. Mixed Wood TG	
				%				39. Hardwood TG	
				%				40. Wasteland	
				%				41. Woodland	
				%				42. Mobile Home Si	
				%				43. Camp Site	
				%				44. Lot Improvemen	
				%				45. BA SF - Oce	
				%				46. SP Meadow Cond	
		Total Acreage		1.60					

Sale Data		
Sale Date	6/04/2019	
Price	330,000	
Sale Type	2 Land & Buildings	
1. Land	4. Mobile	7. COM
2. L & B	5. Other	8.
3. Building	6. Condo	9.
Financing	1 Conventional	
1. Convent	4. Seller	7.
2. FHA/VA	5. Private	8.
3. Assumed	6. Cash	9. Unknown
Validity	1 Arms Length Sale	
1. Valid	4. Split	7. Multiple
2. Related	5. Partial	8. Other
3. Distress	6. Exempt	9. Estate
Verified	5 Public Record	
1. Buyer	4. Agent	7. Family
2. Seller	5. Pub Rec	8. Other
3. Lender	6. MLS	9.

Inspection Witnessed By:

X	Date	Description	Date Insp.

Notes:

Gray

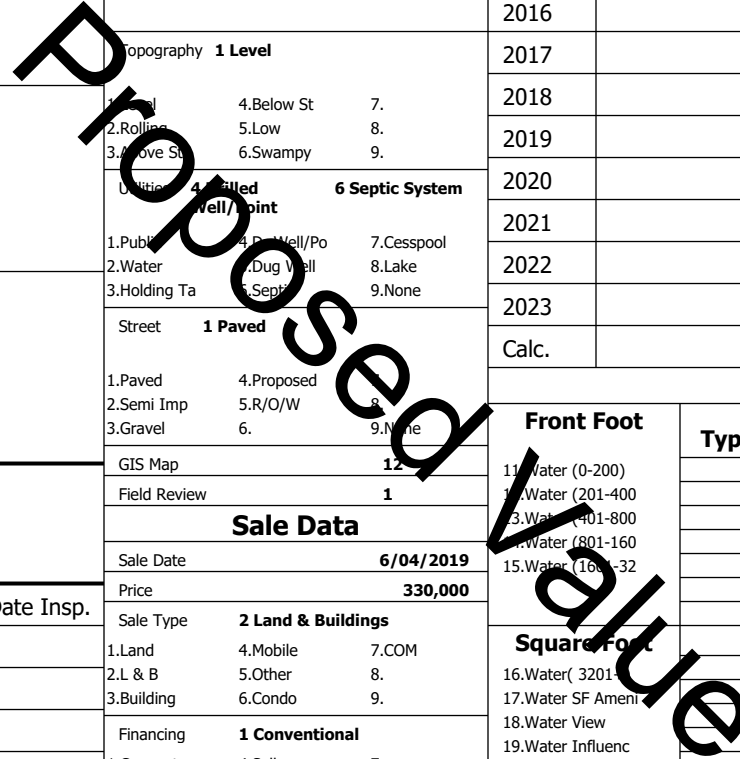

Building Style 10 Colonial	SF Bsmt Living 884	Layout 1 Typical
1.Conv. 5.Garrison 9.NE farm	Fin Bsmt Grade 4 100	1.Typical 4. 7.
2.Ranch 6.Split 10.Colonia	Secondary Heat 0	2.Inadeq 5. 8.
3.R Ranch/ 7.Contemp 11.Cottage	Heat Type 100% 1 Hot Water BB	3. 6. 9.
4.Cape 8.Log 12.Gambrel	1.HWBB 5.FWA 9.None	Attic 9 None
Dwelling Units 1	2.HWCI 6.Monitor 10.UNH2F	1.1/4 Fin 4.Full Fin 7.
Other Units 0	3.HWRF 7.Electric 11.Geother	2.1/2 Fin 5.FI/Stair 8.
Stories 2 Two Story	4.Steam 8.FI/Wall 12.Heat/Co	3.3/4 Fin 6. 9.None
1.1 4.1.5 7.	Cool Type 0% 9 None	Insulation 1 Full
2.2 5.1.75 8.	1.Central 4.W&C Air 7.	1.Full 4.Minimal 7.
3.3 6.2.5 9.	2.Evapor 5. 8.	2.Heavy 5. 8.
Exterior Walls 2 Vinyl/Aluminum	3.H Pump 6. 9.None	3.Capped 6. 9.None
1.Clapboard 5.Stucco 9.B & B	Kitchen Style 2 Typical	Unfinished % 0%
2.Vin/Al 6.Brick 10.Cemplan	1.Modern 4.Obsolete	Grade & Factor 3 Average 120%
3.Compos./ 7.Stone 11.Concret	2.Typical 5. 8.	1.E Grade 4.B Grade 7.SC Grade
4.Asbestos 8.Wood Shi 12.Wood Bo	3.Old Type 6. 9.None	2.D Grade 5.A Grade 8.
Roof Surface 1 Asphalt Shingles	Bath(s) Style 2 Typical Bath(s)	3.Grade 6.AA Grade 9.Same
1.Asphalt 4.Composit 7.Other	1.Modern 4.Obsolete 7.	SQFT (Footprint) 884
2.Slate 5.Wood 8.	2.Typical 5. 8.	Condition 4 Average
3.Metal 6.Roll Roo 9.	3.Old Type 6. 9.None	1.Poor Avg 7.V G
SF Masonry Trim 0	# Rooms 7	2.Fair Avg 8.Exc
SOLAR VOLTAIC 0	# Bedrooms 3	3.Avg- Good 9.Same
OPEN-4- 0	# Full Baths 3	Phys. % Good 0%
Year Built 1996	# Half Baths 0	Funct. % Good 100%
Year Remodeled 0	# Addn Fixtures 1	Functional Code 9 None
Foundation 1 Concrete	# Fireplaces 1	1.Incomp 4.Delap 5.Playo
1.Concrete 4.Wood 7.		2.O-Built 5.Bsmt 8.Long term
2.C Block 5.Slab 8.		3.Damage 6.Style None
3.Br/Stone 6.Piers 9.		Econ. % Good 100%
Basement 4 Full Basement		Economic Code None
1.1/4 Bmt 4.Full Bmt 7.		0.None 3.No Power 6.Obsoles
2.1/2 Bmt 5.CrwI 8.		1.Location 4.Generate 9.None
3.3/4 Bmt 6. 9.None		2.Encroach 5.Flood Pl 9.
Bsmt Gar # Cars 0		Entrance Code 1 Interior Inspect
Wet Basement 1 Dry Basement		1.Interior 4.Vacant 7.
1.Dry 4. 7.		2.Refusal 5.Estimate 8.
2.Damp 5. 8.		3.Informed 6. 9.
3.Wet 6. 9.		Information Code 1 Owner
		1.Owner 4.Agent 7.
		2.Relative 5.Estimate 8.
		3.Tenant 6.Other 9.

Date Inspected 7/15/2015

Additions, Outbuildings & Improvements

Type	Year	Units	Grade	Cond	Phys.	Funct.	Sound Value
4 1 & 1/2 Story Fr	0	192	0 0	0	0	100 %	
21 Open Frame	0	204	0 0	0	0	100 %	
68 Wood Deck	2010	396	0 0	0	0	100 %	
23 Frame Garage	0	1088	3 100	4	0	100 %	
23 Frame Garage	0	480	0 0	0	0	100 %	
79 1/2 St/Garage	0	480	0 0	0	0	100 %	
						%	%
						%	%
						%	%
						%	%
						%	%

