

MAINES, HEATHER M
MAINES, MICHAEL A
368 MAYALL RD
GRAY ME 04039

B18851P129

Property Data			Assessment Record					
Neighborhood	82 Average Location		Year	Land	Buildings	Exempt	Total	
Tree Growth Year	0		2011	51,000	82,965	8,500	125,465	
REVIEW	0		2012	51,000	82,965	8,500	125,465	
Building Permit	0		2013	51,000	82,965	8,500	125,465	
Zone/Land Use	11 Rural Residential & Agri		2014	51,000	82,965	8,500	125,465	
Secondary Zone			2015	51,000	83,000	9,000	125,000	
Topography	1 Level		2016	51,000	83,000	9,000	125,000	
1. Hill	4. Below St	7.	2017	51,000	83,000	13,500	120,500	
2. Rolling	5. Low	8.	2018	51,000	83,000	18,000	116,000	
3. Above St	6. Swampy	9.	2019	64,800	134,200	20,000	179,000	
Utilities	4. Filled Well/Point 6 Septic System		2020	64,800	134,200	20,000	179,000	
1. Public	4. Dug Well/Po	7. Cesspool	2021	64,800	134,200	25,000	174,000	
2. Water	5. Lake	8. Lake	2022	64,800	146,600	25,000	186,400	
3. Holding Ta	6. Septic	9. None	2023	64,800	165,100	25,000	204,900	
Street	1 Paved		Calc.	129,000	186,700	25,000	290,700	
1. Paved	4. Proposed	8.	Land Data					
2. Semi Imp	5. R/O/W	9.	Front Foot	Type	Effective	Influence	Influence Codes	
3. Gravel	6.	9. None	11. Water (0-200)		Frontage	Depth	Factor	Code
GIS Map	10		12. Water (201-400)				%	1. Unimproved
Field Review	1		13. Water (401-800)				%	2. Excess Frtg
Sale Data			14. Water (801-160)				%	3. Topography
Sale Date	2/05/2003		15. Water (161-32)				%	4. Size/Shape
Price	158,000		16. Water (3201-)				%	5. Access
Sale Type			17. Water SF Amen				%	6. Restriction
1. Land	4. Mobile	7. COM	18. Water View				%	7. Open Space
2. L & B	5. Other	8.	19. Water Influen				%	8. Environmental
3. Building	6. Condo	9.	20. ShoreFront A				%	9. Condo
Financing			Square Foot	Square Feet			%	Acres
1. Convent	4. Seller	7.	16. Water (3201-)				%	30. Blueberry(1-20
2. FHA/VA	5. Private	8.	17. Water SF Amen				%	31. Blueberry(21 -
3. Assumed	6. Cash	9. Unknown	18. Water View				%	32. Crop Land
Validity			19. Water Influen				%	33. Pasture
1. Valid	4. Split	7. Multiple	20. ShoreFront A				%	34. Shorefront B
2. Related	5. Partial	8. Other	Fract. Acre				%	35. Shorefront C
3. Distress	6. Exempt	9. Estate	21. Base Lot	21	1.84	100	%	0
Verified			22. Base Lot Vacan	24	4.16	16	%	0
1. Buyer	4. Agent	7. Family	23. Base Lot Unpav				%	
2. Seller	5. Pub Rec	8. Other	Acres				%	
3. Lender	6. MLS	9.	24. Acres to 10				%	
			25. Acres 11-30				%	
			26. Acres 31-50				%	
			27. Acres 51& over				%	
			28. Acres 71 & Ove				%	
			29. Woods (41+)				%	
			Total Acreage	6.00				

Inspection Witnessed By:

No./Date	Description	Date Insp.
X		

Notes:
5/24- DR FIELD REVIEW

Gray

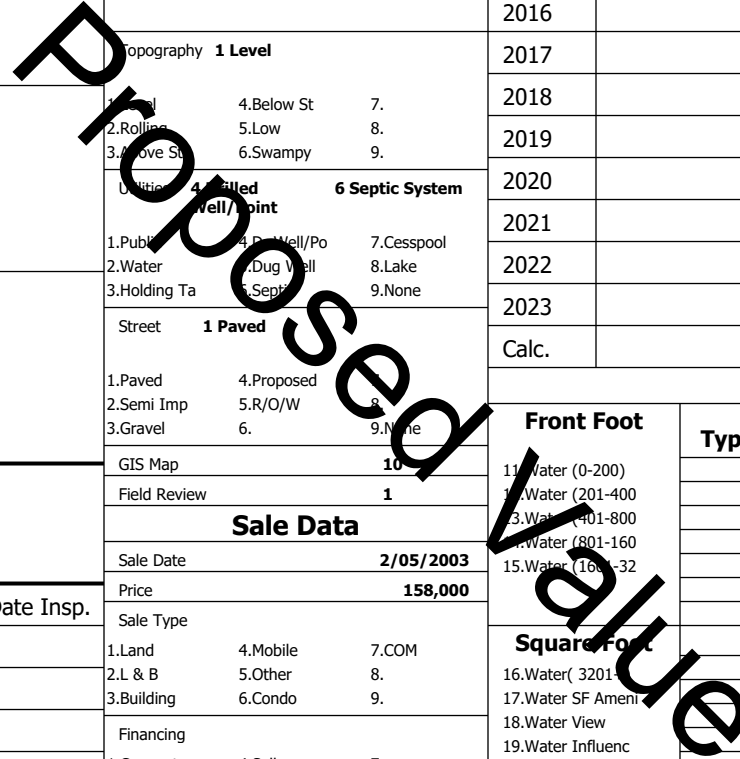

46.SP Meadow Cond

Gray

Map Lot 010-021-008-000

Account 1098

Location 368 MAYALL RD

Card 1

Of 1

8/05/2024

Building Style 2 Ranch	SF Bsmt Living 0	Layout 1 Typical
1.Conv. 5.Garrison 9.NE farm	Fin Bsmt Grade 0 0	1.Typical 4. 7.
2.Ranch 6.Split 10.Colonia	Secondary Heat 0	2.Inadeq 5. 8.
3.R Ranch/ 7.Contemp 11.Cottage	Heat Type 100% 1 Hot Water BB	3. 6. 9.
4.Cape 8.Log 12.Gambrel	1.HWBB 5.FWA 9.None	Attic 9 None
Dwelling Units 1	2.HWCI 6.Monitor 10.UNH2F	1.1/4 Fin 4.Full Fin 7.
Other Units 0	3.HWRF 7.Electric 11.Geother	2.1/2 Fin 5.FI/Stair 8.
Stories 1 One Story	4.Steam 8.FI/Wall 12.Heat/Co	3.3/4 Fin 6. 9.None
1.1 4.1.5 7.	Cool Type 0% 9 None	Insulation 1 Full
2.2 5.1.75 8.	1.Central 4.W&C Air 7.	1.Full 4.Minimal 7.
3.3 6.2.5 9.	2.Evapor 5. 8.	2.Heavy 5. 8.
Exterior Walls 3 Composition/	3.H Pump 6. 9.None	3.Capped 6. 9.None
1.Clapboar 5.Stucco 9.B & B	Kitchen Style 2 Typical	Unfinished % 0%
2.Vin/Al 6.Brick 10.Cemplan	1.Modern 4.Obsolete	Grade & Factor 3 Average 100%
3.Compos./ 7.Stone 11.Concret	2.Typical 5. 8.	1.E Grade 4.B Grade 7.SC Grade
4.Asbestos 8.Wood Shi 12.Wood Bo	3.Old Type 6. 9.None	2.D Grade 5.A Grade 8.
Roof Surface 1 Asphalt Shingles	Bath(s) Style 2 Typical Bath(s)	3.C Grade 6.AA Grade 9.Same
1.Asphalt 4.Composit 7.Other	1.Modern 4.Obsolete 7.	SQFT (Footprint) 1196
2.Slate 5.Wood 8.	2.Typical 5. 8.	Condition 4 Average
3.Metal 6.Roll Roo 9.	3.Old Type 6. 9.None	1.Poor Avg 7.V G
SF Masonry Trim 0	# Rooms 5	2.Fair Avg 8.Exc
SOLAR VOLTAIC 0	# Bedrooms 2	3.Avg- Good 9.Same
OPEN-4- 0	# Full Baths 1	Phys. % Good 0%
Year Built 1976	# Half Baths 0	Funct. % Good 100%
Year Remodeled 0	# Addn Fixtures 0	Functional Code 9 None
Foundation 1 Concrete	# Fireplaces 0	1.Incomp 4.Delap 9.No
1.Concrete 4.Wood 7.		2.O-Built 5.Bsmt 8.Long term
2.C Block 5.Slab 8.		3.Damage 6.Style 9.None
3.Br/Stone 6.Piers 9.		Econ. % Good 100%
Basement 4 Full Basement		Economic Code None
1.1/4 Bmt 4.Full Bmt 7.		0.None 3.No Power 6.Obsolete
2.1/2 Bmt 5.Crwl 8.		1.Location 4.Generate 9.None
3.3/4 Bmt 6. 9.None		2.Encroach 5.Flood Pl 9.
Bsmt Gar # Cars 2		Entrance Code 5 Estimated
Wet Basement 1 Dry Basement		1.Interior 4.Vacant 7.
1.Dry 4. 7.		2.Refusal 5.Estimate 8.
2.Damp 5. 8.		3.Informed 6. 9.
3.Wet 6. 9.		Information Code 5 Estimate
		1.Owner 4.Agent 7.
		2.Relative 5.Estimate 8.
		3.Tenant 6.Other 9.

Date Inspected 5/16/2024

Additions, Outbuildings & Improvements

Type	Year	Units	Grade	Cond	Phys.	Funct.	Sound Value
68 Wood Deck	0	228	0 0	0	0 %	100 %	
24 Frame Shed	2003	200	1 100	3	0 %	100 %	1.One Story Fram
24 Frame Shed	2006	164	3 100	3	0 %	100 %	2.Two Story Fram
24 Frame Shed	2009	120	3 100	3	0 %	100 %	3.Three Story Fr
					%	%	4.1 & 1/2 Story
					%	%	5.1 & 3/4 Story
					%	%	6.2 & 1/2 Story
					%	%	21.Open Frame Por
					%	%	22.Encl Frame Por
					%	%	23.Frame Garage
					%	%	24.Frame Shed
					%	%	25.Frame Bay Wind
					%	%	26.1SFr Overhang
					%	%	27.Unfin Basement
					%	%	28.Unfinished Att
					%	%	29.Finished Attic

