

SINFORD, LANCE M
393 MAYALL ROAD
GRAY ME 04039

B21849P190

Property Data			Assessment Record				
Neighborhood	82 Average Location		Year	Land	Buildings	Exempt	Total
Tree Growth Year	0		2011	47,000	88,892	8,500	127,392
REVIEW	0		2012	47,000	88,892	8,500	127,392
Building Permit	0		2013	47,000	88,892	8,500	127,392
Zone/Land Use	11 Rural Residential & Agri		2014	47,000	88,892	8,500	127,392
Secondary Zone			2015	47,000	88,900	9,000	126,900
Topography	1 Level		2016	47,000	88,900	9,000	126,900
1. Hill	4. Below St	7.	2017	47,000	88,900	13,500	122,400
2. Rolling	5. Low	8.	2018	47,000	88,900	18,000	117,900
3. Above St	6. Swampy	9.	2019	63,200	149,800	20,000	193,000
Utilities	4. Filled Well/Point		2020	63,200	149,800	20,000	193,000
1. Public	4. Dug Well/Po	7. Cesspool	2021	63,200	149,800	25,000	188,000
2. Water	5. Dug Well	8. Lake	2022	63,200	149,800	25,000	188,000
3. Holding Ta	6. Septic	9. None	2023	63,200	169,000	25,000	207,200
Street	1 Paved		Calc.	125,400	234,300	25,000	334,700
1. Paved	4. Proposed	8.	Land Data				
2. Semi Imp	5. R/O/W	9.	Front Foot	Type	Effective	Influence	Influence
3. Gravel	6.	9.	11. Water (0-200)		Frontage	Depth	Factor
GIS Map	10		12. Water (201-400)				Code
Field Review	1		13. Water (401-800)				1. Unimproved
Sale Data			14. Water (801-160)				2. Excess Frtg
Sale Date	7/19/2005		15. Water (1601-32)				3. Topography
Price			Square Foot				4. Size/Shape
Sale Type			16. Water (3201-				5. Access
1. Land	4. Mobile	7.COM	17. Water SF Amen				6. Restriction
2. L & B	5. Other	8.	18. Water View				7. Open Space
3. Building	6. Condo	9.	19. Water Influen				8. Environmental
Financing			20. ShoreFront A				9. Condo
1. Convent	4. Seller	7.	Fract. Acre				Acres
2. FHA/VA	5. Private	8.	21. Base Lot	21	1.84	100 %	30. Blueberry(1-20
3. Assumed	6. Cash	9.Unknown	22. Base Lot Vacan	24	0.06	100 %	31. Blueberry(21 -
Validity			23. Base Lot Unpav				32. Crop Land
1. Valid	4. Split	7. Multiple	Acres				33. Pasture
2. Related	5. Partial	8. Other	24. Acres to 10				34. Shorefront B
3. Distress	6. Exempt	9. Estate	25. Acres 11-30				35. Shorefront C
Verified			26. Acres 31-50				36. ANTENNA SITE
1. Buyer	4. Agent	7. Family	27. Acres 51& over				37. Softwood TG
2. Seller	5. Pub Rec	8. Other	28. Acres 71 & Ove				38. Mixed Wood TG
3. Lender	6. MLS	9.	29. Woods (41+)				39. Hardwood TG
				Total Acreage		1.90	40. Wasteland
							41. Woodland
							42. Mobile Home Si
							43. Camp Site
							44. Lot Improvemen
							45. BA SF - Oce
							46. SP Meadow Cond

Inspection Witnessed By:

X	Date	Description	Date Insp.

Notes:
5/24- DR FIELD REVIEW

Gray

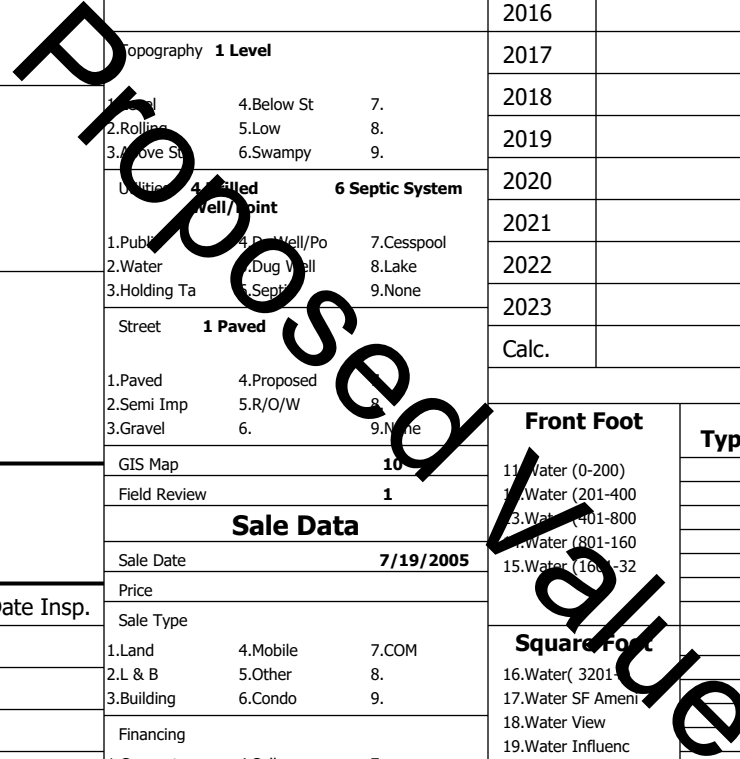

Gray

Map Lot 010-021-007-004

Account 1137

Location 393 MAYALL RD

Card 1

Of 1

8/05/2024

Building Style 2 Ranch	SF Bsmt Living 0	Layout 1 Typical
1.Conv. 5.Garrison 9.NE farm	Fin Bsmt Grade 0 0	1.Typical 4. 7.
2.Ranch 6.Split 10.Colonia	Secondary Heat 0	2.Inadeq 5. 8.
3.R Ranch/ 7.Contemp 11.Cottage	Heat Type 100% 1 Hot Water BB	3. 6. 9.
4.Cape 8.Log 12.Gambrel	1.HWBB 5.FWA 9.None	Attic 9 None
Dwelling Units 1	2.HWCI 6.Monitor 10.UNH2F	1.1/4 Fin 4.Full Fin 7.
Other Units 0	3.HWRF 7.Electric 11.Geother	2.1/2 Fin 5.FI/Stair 8.
Stories 1 One Story	4.Steam 8.FI/Wall 12.Heat/Co	3.3/4 Fin 6. 9.None
1.1 4.1.5 7.	Cool Type 0% 9 None	Insulation 1 Full
2.2 5.1.75 8.	1.Central 4.W&C Air 7.	1.Full 4.Minimal 7.
3.3 6.2.5 9.	2.Evapor 5. 8.	2.Heavy 5. 8.
Exterior Walls 1 Clapboard	3.H Pump 6. 9.None	3.Capped 6. 9.None
1.Clapboar 5.Stucco 9.B & B	Kitchen Style 2 Typical	Unfinished % 0%
2.Vin/Al 6.Brick 10.Cemplan	1.Modern 4.Obsolete	Grade & Factor 3 Average 110%
3.Compos./ 7.Stone 11.Concret	2.Typical 5. 8.	1.E Grade 4.B Grade 7.SC Grade
4.Asbestos 8.Wood Shi 12.Wood Bo	3.Old Type 6. 9.None	2.C Grade 5.A Grade 8.
Roof Surface 1 Asphalt Shingles	Bath(s) Style 2 Typical Bath(s)	3.Grade 6.AA Grade 9.Same
1.Asphalt 4.Composit 7.Other	1.Modern 4.Obsolete 7.	SQFT (Footprint) 960
2.Slate 5.Wood 8.	2.Typical 5. 8.	Foundation 4 Average
3.Metal 6.Roll Roo 9.	3.Old Type 6. 9.None	1.Poor 2.Avg 7.V G
SF Masonry Trim 0	# Rooms 6	2.Fair 3.Avg 8.Exc
SOLAR VOLTAIC 0	# Bedrooms 3	3.Avg- 4.Good 9.Same
OPEN-4- 0	# Full Baths 1	Phys. % Good 0%
Year Built 1984	# Half Baths 0	Funct. % Good 100%
Year Remodeled 0	# Addn Fixtures 0	Functional Code 9 None
Foundation 1 Concrete	# Fireplaces 0	1.Incomp 4.Delap 5.Delay
1.Concrete 4.Wood 7.		2.O-Built 5.Bsmt 6.Long term
2.C Block 5.Slab 8.		3.Damage 6.Style 7.None
3.Br/Stone 6.Piers 9.		Econ. % Good 100%
Basement 4 Full Basement		Economic Code None
1.1/4 Bmt 4.Full Bmt 7.		0.None 3.No Power 6.Obsoles
2.1/2 Bmt 5.Crwl 8.		1.Location 4.Generate 9.None
3.3/4 Bmt 6. 9.None		2.Encroach 5.Flood Pl 9.
Bsmt Gar # Cars 0		Entrance Code 5 Estimated
Wet Basement 1 Dry Basement		1.Interior 4.Vacant 7.
1.Dry 4. 7.		2.Refusal 5.Estimate 8.
2.Damp 5. 8.	3.Informed 6. 9.	
3.Wet 6. 9.	Information Code 5 Estimate	
	1.Owner 4.Agent 7.	
	2.Relative 5.Estimate 8.	
	3.Tenant 6.Other 9.	

Date Inspected 5/16/2024

Additions, Outbuildings & Improvements

Type	Year	Units	Grade	Cond	Phys.	Funct.	Sound Value
1 One Story Frame	1995	247	0 0	0	0 %	100 %	1.One Story Fram
24 Frame Shed	0	240	3 100	0	0 %	100 %	2.Two Story Fram
23 Frame Garage	0	624	0 0	0	0 %	100 %	3.Three Story Fr
21 Open Frame	0	82	0 0	0	0 %	100 %	4.1 & 1/2 Story
68 Wood Deck	0	227	0 0	0	0 %	100 %	5.1 & 3/4 Story
					%	%	6.2 & 1/2 Story
					%	%	21.Open Frame Por
					%	%	22.Encl Frame Por
					%	%	23.Frame Garage
					%	%	24.Frame Shed
					%	%	25.Frame Bay Wind
					%	%	26.1SFr Overhang
					%	%	27.Unfin Basement
					%	%	28.Unfinished Att
					%	%	29.Finished Attic

