

ROGERS, ROBERT E
ROGERS, CINDY P
72 BLUEBERRY LANE
GRAY ME 04039

B39537P131

Previous Owner
FARREN, BARBARA J
252 NORTH RAYMOND ROAD

RAYMOND ME 04071
Sale Date: 6/29/2022

Previous Owner
COOK - DEVISEES, ROBERT E
C/O RICHARD J FARREN JR
PERSONAL REPRESENTATIVE
HAVERHILL MA 01832
Sale Date: 5/27/2022

Previous Owner
COOK, ROBERT E
72 BLUEBERRY LANE

GRAY ME 04039
Sale Date: 11/04/2021

Inspection Witnessed By:

| X | Date | Description | Date Insp. |
|---|------|-------------|------------|
| | | | |
| | | | |
| | | | |

Notes:
5/24- DR FIELD REVIEW

Gray

| Property Data | | | Assessment Record | | | | | |
|------------------|--------------------------------------|-------------|------------------------|----------------------|----------------------|------------------|------------------------|--------------------|
| Neighborhood | 83 Avg-Good Location | | Year | Land | Buildings | Exempt | Total | |
| Tree Growth Year | 0 | | 2011 | 57,100 | 129,626 | 0 | 186,726 | |
| REVIEW | 0 | | 2012 | 57,100 | 129,626 | 0 | 186,726 | |
| Building Permit | 0 | | 2013 | 57,100 | 129,626 | 0 | 186,726 | |
| Zone/Land Use | 11 Rural Residential & Agri | | 2014 | 57,100 | 132,218 | 0 | 189,318 | |
| Secondary Zone | | | 2015 | 57,100 | 132,200 | 0 | 189,300 | |
| Topography | 1 Level | | 2016 | 57,100 | 132,200 | 0 | 189,300 | |
| 1. Well | 4. Below St | 7. | 2017 | 57,100 | 134,800 | 0 | 191,900 | |
| 2. Rolling | 5. Low | 8. | 2018 | 57,100 | 134,800 | 0 | 191,900 | |
| 3. Above St | 6. Swampy | 9. | 2019 | 65,800 | 191,800 | 0 | 257,600 | |
| Utilities | 4. Filled Well/Point 6 Septic System | | 2020 | 65,800 | 194,400 | 0 | 260,200 | |
| 1. Public | 4. Driv Well/Po | 7. Cesspool | 2021 | 65,700 | 194,400 | 25,000 | 235,100 | |
| 2. Water | 5. Dug Well | 8. Lake | 2022 | 65,700 | 194,400 | 25,000 | 235,100 | |
| 3. Holding Ta | 6. Septic | 9. None | 2023 | 65,700 | 223,000 | 0 | 288,700 | |
| Street | 1 Paved | | Calc. | 139,000 | 311,900 | 0 | 450,900 | |
| 1. Paved | 4. Proposed | 7. | Land Data | | | | | |
| 2. Semi Imp | 5. R/O/W | 8. | Front Foot | Type | Effective | Influence | Influence Codes | |
| 3. Gravel | 6. | 9. None | 11. Water (0-200) | | Frontage | Depth | Factor | Code |
| GIS Map | 9 | | 12. Water (201-400) | | | | % | 1. Unimproved |
| Field Review | 1 | | 13. Water (401-800) | | | | % | 2. Excess Frtg |
| Sale Data | | | 14. Water (801-160) | | | | % | 3. Topography |
| Sale Date | 6/29/2022 | | 15. Water (161-320) | | | | % | 4. Size/Shape |
| Price | 455,000 | | 16. Water (3201-6400) | | | | % | 5. Access |
| Sale Type | 2 Land & Buildings | | 17. Water SF Amenities | | | | % | 6. Restriction |
| 1. Land | 4. Mobile | 7. COM | 18. Water View | | | | % | 7. Open Space |
| 2. L & B | 5. Other | 8. | 19. Water Influenc | | | | % | 8. Environmental |
| 3. Building | 6. Condo | 9. | 20. ShoreFront A | | | | % | 9. Condo |
| Financing | 1 Conventional | | Square Foot | | Square Feet | | | Acres |
| 1. Convent | 4. Seller | 7. | 16. Water (3201-6400) | | | | % | 30. Blueberry(1-20 |
| 2. FHA/VA | 5. Private | 8. | 17. Water SF Amenities | | | | % | 31. Blueberry(21 - |
| 3. Assumed | 6. Cash | 9. Unknown | 18. Water View | | | | % | 32. Crop Land |
| Validity | 1 Arms Length Sale | | 19. Water Influenc | | | | % | 33. Pasture |
| 1. Valid | 4. Split | 7. Multiple | 20. ShoreFront A | | | | % | 34. Shorefront B |
| 2. Related | 5. Partial | 8. Other | Fract. Acre | | Acreege/Sites | | | 35. Shorefront C |
| 3. Distress | 6. Exempt | 9. Estate | 21. Base Lot | 21 | 1.84 | 100 | % | 0 |
| Verified | 5 Public Record | | 22. Base Lot Vacan | 24 | 0.22 | 100 | % | 0 |
| 1. Buyer | 4. Agent | 7. Family | 23. Base Lot Unpav | | | | % | |
| 2. Seller | 5. Pub Rec | 8. Other | Acres | | | | % | |
| 3. Lender | 6. MLS | 9. | 24. Acres to 10 | | | | % | |
| | | | 25. Acres 11-30 | | | | % | |
| | | | 26. Acres 31-50 | | | | % | |
| | | | 27. Acres 51& over | | | | % | |
| | | | 28. Acres 71 & Ove | | | | % | |
| | | | 29. Woods (41+) | | | | % | |
| | | | | Total Acreage | | 2.06 | | |

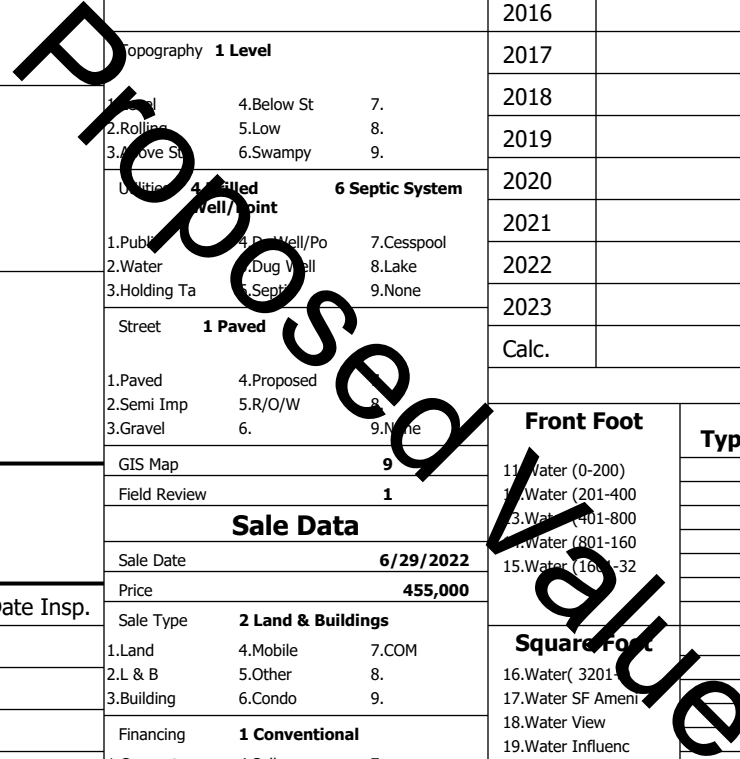

45. BA SF - Oce
46. SP Meadow Cond

