

BURKE, KAREN A
BURKE, JOHN J
PO BOX 846
GRAY ME 04039

B23126P3

Property Data		
Neighborhood	2 Crystal Lake 1	
Tree Growth Year	0	
REVIEW	0	
Building Permit	0	
Zone/Land Use	12 Limited Residential	
Secondary Zone		
Topography	2 Rolling	4 Below Street
1. Hill	4. Below St	7.
2. Rolling	5. Low	8.
3. Above St	6. Swampy	9.
Utilities	4. Filled Well/Point	6 Septic System
1. Public	4. Dug Well/Po	7. Cesspool
2. Water	5. Dug Well	8. Lake
3. Holding Ta	6. Septic	9. None
Street	1 Paved	
1. Paved	4. Proposed	8.
2. Semi Imp	5. R/O/W	9.
3. Gravel	6.	9. None
GIS Map	8	
Field Review	1	

Inspection Witnessed By:

X		Date
No./Date	Description	Date Insp.

Notes:

Gray

Assessment Record				
Year	Land	Buildings	Exempt	Total
2011	193,100	124,145	0	317,245
2012	193,100	124,145	8,500	308,745
2013	193,100	124,145	8,500	308,745
2014	193,100	127,394	8,500	311,994
2015	193,100	127,400	9,000	311,500
2016	193,100	127,400	9,000	311,500
2017	193,100	127,400	13,500	307,000
2018	193,100	127,400	18,000	302,500
2019	247,700	141,900	20,000	369,600
2020	247,700	141,900	20,000	369,600
2021	247,700	141,900	25,000	364,600
2022	247,700	141,900	25,000	364,600
2023	247,700	169,700	25,000	392,400
Calc.	516,400	243,700	25,000	735,100

Land Data						
Front Foot	Type	Effective		Influence		Influence Codes
		Frontage	Depth	Factor	Code	
11. Water (0-200)	11	185	000	100 %	0	1. Unimproved
12. Water (201-400)				%		2. Excess Frtg
13. Water (401-800)				%		3. Topography
14. Water (801-160)				%		4. Size/Shape
15. Water (1601-32)				%		5. Access
				%		6. Restriction
				%		7. Open Space
				%		8. Environmental
				%		9. Condo
Square Foot		Square Feet				Acres
16. Water (3201-				%		30. Blueberry(1-20
17. Water SF Amen				%		31. Blueberry(21 -
18. Water View				%		32. Crop Land
19. Water Influen				%		33. Pasture
20. ShoreFront A				%		34. Shorefront B
				%		35. Shorefront C
				%		36. ANTENNA SITE
				%		37. Softwood TG
				%		38. Mixed Wood TG
				%		39. Hardwood TG
				%		40. Wasteland
				%		41. Woodland
				%		42. Mobile Home Si
				%		43. Camp Site
				%		44. Lot Improvemen
				%		45. BA SF - Oce
				%		46. SP Meadow Cond
Fract. Acre		Acreage/Sites				
21. Base Lot	20		0.90	100 %	0	
22. Base Lot Vacan				%		
23. Base Lot Unpav				%		
Acres						
24. Acres to 10				%		
25. Acres 11-30				%		
26. Acres 31-50				%		
27. Acres 51& over				%		
28. Acres 71 & Ove				%		
29. Woods (41+)				%		
Total Acreage		0.90				

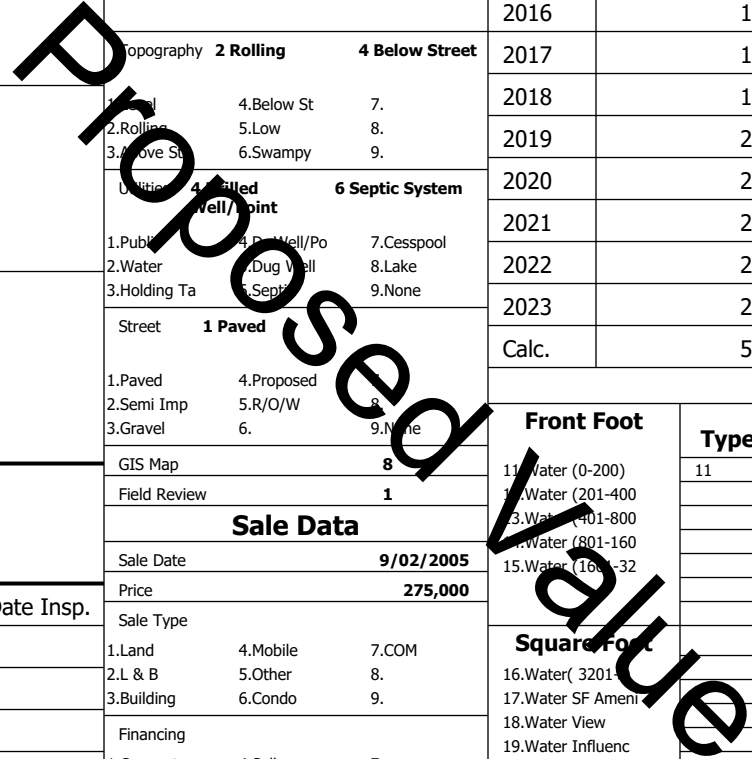

Gray

Map Lot 008-105-016-000

Account 3129

Location 122 MAYBERRY RD

Card 1

Of 1

8/05/2024

Building Style 4 Cape Cod	SF Bsmt Living 0	Layout 1 Typical
1.Conv. 5.Garrison 9.NE farm	Fin Bsmt Grade 0 0	1.Typical 4. 7.
2.Ranch 6.Split 10.Colonia	Secondary Heat 0	2.Inadeq 5. 8.
3.R Ranch/ 7.Contemp 11.Cottage	Heat Type 100% 5 Forced Warm Air	3. 6. 9.
4.Cape 8.Log 12.Gambrel	1.HWBB 5.FWA 9.None	Attic 9 None
Dwelling Units 1	2.HWCI 6.Monitor 10.UNH2F	1.1/4 Fin 4.Full Fin 7.
Other Units 0	3.HWRF 7.Electric 11.Geother	2.1/2 Fin 5.FI/Stair 8.
Stories 5 One & 3/4 Story	4.Steam 8.FI/Wall 12.Heat/Co	3.3/4 Fin 6. 9.None
1.1 4.1.5 7.	Cool Type 0% 9 None	Insulation 1 Full
2.2 5.1.75 8.	1.Central 4.W&C Air 7.	1.Full 4.Minimal 7.
3.3 6.2.5 9.	2.Evapor 5. 8.	2.Heavy 5. 8.
Exterior Walls 13 Log	3.H Pump 6. 9.None	3.Capped 6. 9.None
1.Clapboar 5.Stucco 9.B & B	Kitchen Style 2 Typical	Unfinished % 0%
2.Vin/Al 6.Brick 10.Cemplan	1.Modern 4.Obsolete	Grade & Factor 3 Average 110%
3.Compos./ 7.Stone 11.Concret	2.Typical 5. 8.	1.E Grade 4.B Grade 7.SC Grade
4.Asbestos 8.Wood Shi 12.Wood Bo	3.Old Type 6. 9.None	2.C Grade 5.A Grade 8.
Roof Surface 3 Metal	Bath(s) Style 2 Typical Bath(s)	3.C Grade 6.AA Grade 9.Same
1.Asphalt 4.Composit 7.Other	1.Modern 4.Obsolete 7.	SQFT (Footprint) 704
2.Slate 5.Wood 8.	2.Typical 5. 8.	Condition 5 Good
3.Metal 6.Roll Roo 9.	3.Old Type 6. 9.None	1.Poor Avg 7.V G
SF Masonry Trim 0	# Rooms 6	2.Fair Avg 8.Exc
SOLAR VOLTAIC 0	# Bedrooms 2	3.Avg- Good 9.Same
OPEN-4- 0	# Full Baths 2	Phys. % Good 0%
Year Built 1980	# Half Baths 0	Funct. % Good 100%
Year Remodeled 2010	# Addn Fixtures 0	Functional Code 9 None
Foundation 1 Concrete	# Fireplaces 0	1.Incomp 4.Delap 9.No
1.Concrete 4.Wood 7.	<div style="border: 1px solid black; padding: 10px; display: inline-block;"> T TRIO </div>	2.O-Built 5.Bsmt 8.Long term
2.C Block 5.Slab 8.		3.Damage 6.Style 9.None
3.Br/Stone 6.Piers 9.		Econ. % Good 100%
Basement 4 Full Basement		Economic Code None
1.1/4 Bmt 4.Full Bmt 7.		0.None 3.No Power 6.Obsolete
2.1/2 Bmt 5.Crw 8.		1.Location 4.Generate 9.None
3.3/4 Bmt 6. 9.None		2.Encroach 5.Flood Pl 9.
Bsmt Gar # Cars 0		Entrance Code 1 Interior Inspect
Wet Basement 1 Dry Basement		1.Interior 4.Vacant 7.
1.Dry 4. 7.		2.Refusal 5.Estimate 8.
2.Damp 5. 8.	3.Informed 6. 9.	
3.Wet 6. 9.	Information Code 1 Owner	
	1.Owner 4.Agent 7.	
	2.Relative 5.Estimate 8.	
	3.Tenant 6.Other 9.	

Date Inspected 6/29/2015

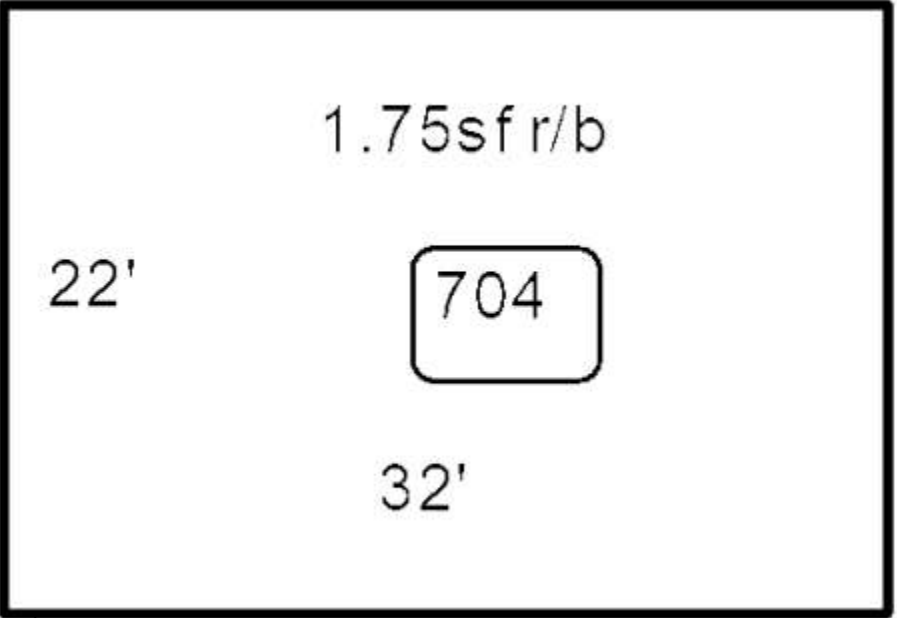

Additions, Outbuildings & Improvements							
Type	Year	Units	Grade	Cond	Phys.	Funct.	Sound Value
24 Frame Shed	0	120	3 100	4	0 %	100 %	
					%	%	
					%	%	
					%	%	
					%	%	
					%	%	
					%	%	
					%	%	
					%	%	
					%	%	
					%	%	
					%	%	
					%	%	
					%	%	
					%	%	
					%	%	
					%	%	
					%	%	
					%	%	
					%	%	
					%	%	

Value