

RIDGE, THOMAS M
100 NORTH RAYMOND RD
GRAY ME 04039

B28840P28

Inspection Witnessed By:

X	Date	Description	Date Insp.

Notes:

Gray

Property Data			Assessment Record						
Neighborhood 82 Average Location			Year	Land	Buildings	Exempt	Total		
Tree Growth Year 0			2011	47,500	141,983	8,500	180,983		
REVIEW 0			2012	47,500	145,093	8,500	184,093		
Building Permit 0			2013	47,500	145,093	8,500	184,093		
Zone/Land Use 11 Rural Residential & Agri			2014	47,500	149,650	8,500	188,650		
Secondary Zone			2015	47,500	149,700	9,000	188,200		
Topography 2 Rolling			2016	47,500	149,700	9,000	188,200		
1. Hill 4. Below St 7.			2017	47,500	155,000	13,500	189,000		
2. Rolling 5. Low 8.			2018	47,500	155,000	18,000	184,500		
3. Above St 6. Swampy 9.			2019	72,000	183,200	20,000	235,200		
Utilities 4 Filled Well/Point 6 Septic System			2020	72,000	183,200	20,000	235,200		
1. Public 4. Dug Well/Po 7. Cesspool			2021	72,000	183,200	25,000	230,200		
2. Water 8. Lake			2022	72,000	183,200	25,000	230,200		
3. Holding Ta 9. None			2023	72,000	210,900	25,000	257,900		
Street 1 Paved			Calc.	129,000	300,600	25,000	404,600		
1. Paved 4. Proposed			Land Data						
2. Semi Imp 5. R/O/W			Front Foot	Type	Effective		Influence		Influence Codes
3. Gravel 6. None					Frontage	Depth	Factor	Code	
GIS Map 8			11. Water (0-200)				%		1. Unimproved
Field Review 1			12. Water (201-400)				%		2. Excess Frtg
Sale Data			13. Water (401-800)				%		3. Topography
Sale Date 7/22/2011			14. Water (801-160)				%		4. Size/Shape
Price			15. Water (161-32)				%		5. Access
Sale Type							%		6. Restriction
1. Land 4. Mobile 7.COM			Square Foot	Square Feet					7. Open Space
2. L & B 5. Other 8.			16. Water (3201-				%		8. Environmental
3. Building 6. Condo 9.			17. Water SF Amen				%		9. Condo
Financing			18. Water View				%		Acres
1. Convent 4. Seller 7.			19. Water Influen				%		30. Blueberry(1-20
2. FHA/VA 5. Private 8.			20. ShoreFront A				%		31. Blueberry(21 -
3. Assumed 6. Cash 9.Unknown							%		32. Crop Land
Validity			Fract. Acre	Acres/Sites					33. Pasture
1. Valid 4. Split 7. Multiple			21. Base Lot	21	1.84	100	%	0	34. Shorefront B
2. Related 5. Partial 8. Other			22. Base Lot Vacan	24	0.66	100	%	0	35. Shorefront C
3. Distress 6. Exempt 9. Estate			23. Base Lot Unpav				%		36. ANTENNA SITE
Verified			Acres				%		37. Softwood TG
1. Buyer 4. Agent 7. Family			24. Acres to 10				%		38. Mixed Wood TG
2. Seller 5. Pub Rec 8. Other			25. Acres 11-30				%		39. Hardwood TG
3. Lender 6. MLS 9.			26. Acres 31-50				%		40. Wasteland
			27. Acres 51& over				%		41. Woodland
			28. Acres 71 & Ove				%		42. Mobile Home Si
			29. Woods (41+)				%		43. Camp Site
			Total Acreage		2.50				44. Lot Improvemen
									45. BA SF - Oce
									46. SP Meadow Cond

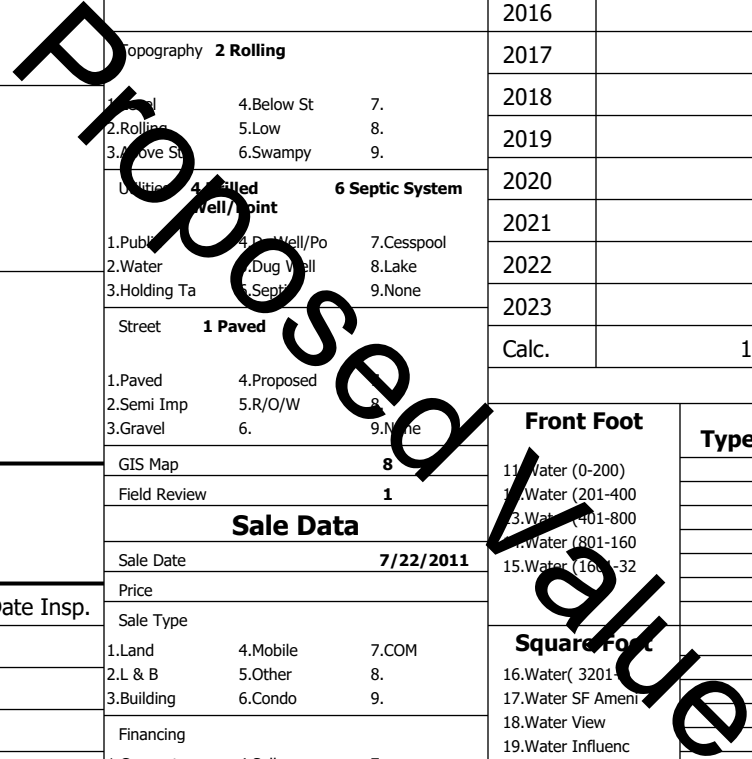

Gray

Map Lot 008-010-019-000

Account 344

Location 100 NORTH RAYMOND RD

Card 1 Of 1

8/05/2024

Building Style 4 Cape Cod	SF Bsmt Living 0	Layout 1 Typical
1.Conv. 5.Garrison 9.NE farm	Fin Bsmt Grade 0 0	1.Typical 4. 7.
2.Ranch 6.Split 10.Colonia	Secondary Heat 2	2.Inadeq 5. 8.
3.R Ranch/ 7.Contemp 11.Cottage	Heat Type 100% 1 Hot Water BB	3. 6. 9.
4.Cape 8.Log 12.Gambrel	1.HWBB 5.FWA 9.None	Attic 5 Floor & Stairs
Dwelling Units 1	2.HWCI 6.Monitor 10.UNH2F	1.1/4 Fin 4.Full Fin 7.
Other Units 0	3.HWRF 7.Electric 11.Geother	2.1/2 Fin 5.F/Stair 8.
Stories 4 One & 1/2 Story	4.Steam 8.F/Wall 12.Heat/Co	3.3/4 Fin 6. 9.None
1.1 4.1.5 7.	Cool Type 0% 9 None	Insulation 1 Full
2.2 5.1.75 8.	1.Central 4.W&C Air 7.	1.Full 4.Minimal 7.
3.3 6.2.5 9.	2.Evapor 5. 8.	2.Heavy 5. 8.
Exterior Walls 1 Clapboard	3.H Pump 6. 9.None	3.Capped 6. 9.None
1.Clapboar 5.Stucco 9.B & B	Kitchen Style 2 Typical	Unfinished % 0%
2.Vin/Al 6.Brick 10.Cemplan	1.Modern 4.Obsolete	Grade & Factor 3 Average 110%
3.Compos./ 7.Stone 11.Concret	2.Typical 5. 8.	1.E Grade 4.B Grade 7.SC Grade
4.Asbestos 8.Wood Shi 12.Wood Bo	3.Old Type 6. 9.None	2.D Grade 5.A Grade 8.
Roof Surface 1 Asphalt Shingles	Bath(s) Style 2 Typical Bath(s)	3.Grade 6.AA Grade 9.Same
1.Asphalt 4.Composit 7.Other	1.Modern 4.Obsolete 7.	SQFT (Footprint) 896
2.Slate 5.Wood 8.	2.Typical 5. 8.	Condition 5 Good
3.Metal 6.Roll Roo 9.	3.Old Type 6. 9.None	1.Poor Avg 7.V G
SF Masonry Trim 0	# Rooms 6	2.Fair Avg 8.Exc
SOLAR VOLTAIC 0	# Bedrooms 3	3.Avg- Good 9.Same
OPEN-4- 0	# Full Baths 2	Phys. % Good 0%
Year Built 1989	# Half Baths 0	Funct. % Good 100%
Year Remodeled 0	# Addn Fixtures 0	Functional Code 9 None
Foundation 1 Concrete	# Fireplaces 0	1.Incomp 4.Delap 7.Layo
1.Concrete 4.Wood 7.		2.O-Built 5.Bsmt 8.Long term
2.C Block 5.Slab 8.		3.Damage 6.Style None
3.Br/Stone 6.Piers 9.		Econ. % Good 100%
Basement 4 Full Basement		Economic Code None
1.1/4 Bmt 4.Full Bmt 7.		0.None 3.No Power 6.Obsolete
2.1/2 Bmt 5.Crw 8.		1.Location 4.Generate 9.None
3.3/4 Bmt 6. 9.None		2.Encroach 5.Flood Pl 9.
Bsmt Gar # Cars 0		Entrance Code 1 Interior Inspect
Wet Basement 1 Dry Basement		1.Interior 4.Vacant 7.
1.Dry 4. 7.		2.Refusal 5.Estimate 8.
2.Damp 5. 8.		3.Informed 6. 9.
3.Wet 6. 9.		Information Code 1 Owner
		1.Owner 4.Agent 7.
		2.Relative 5.Estimate 8.
		3.Tenant 6.Other 9.

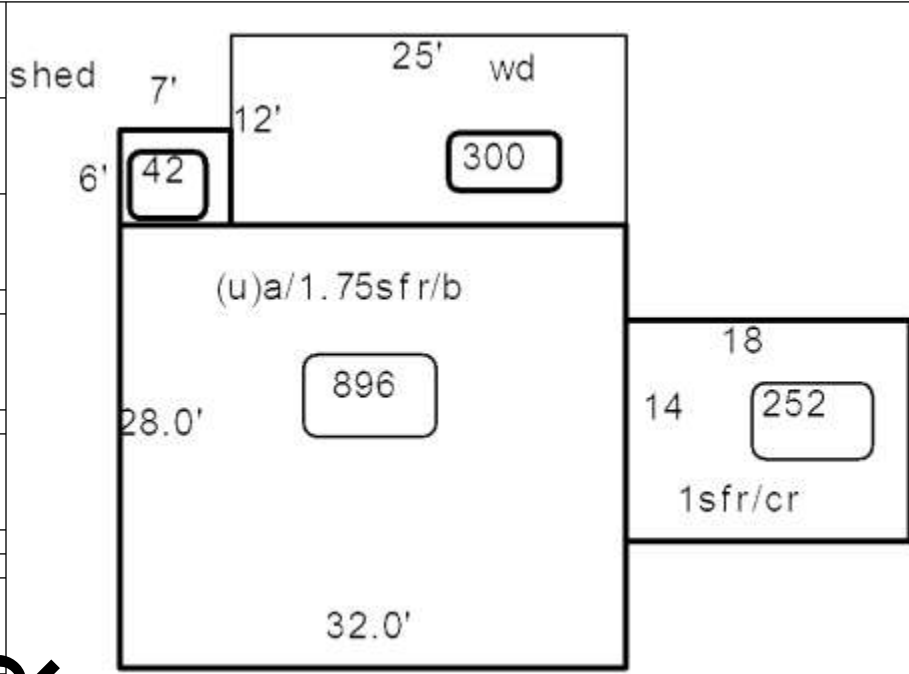

Date Inspected 7/16/2015

Additions, Outbuildings & Improvements

Type	Year	Units	Grade	Cond	Phys.	Funct.	Sound Value
1 One Story Frame	0	252	0 0	0	0 %	100 %	
24 Frame Shed	0	42	3 100	4	0 %	100 %	
68 Wood Deck	2010	300	3 100	4	0 %	100 %	
24 Frame Shed	1990	216	3 100	4	0 %	100 %	
					%	%	
					%	%	
					%	%	
					%	%	
					%	%	
					%	%	
					%	%	
					%	%	

- 1.One Story Fram
- 2.Two Story Fram
- 3.Three Story Fr
- 4.1 & 1/2 Story
- 5.1 & 3/4 Story
- 6.2 & 1/2 Story
- 21.Open Frame Por
- 22.Encl Frame Por
- 23.Frame Garage
- 24.Frame Shed
- 25.Frame Bay Wind
- 26.1SFr Overhang
- 27.Unfin Basement
- 28.Unfinished Att
- 29.Finished Attic