

BOUCHARD, LUCAS A
BOUCHARD, AMY S
12 MAY MEADOW DRIVE
GRAY ME 04039

B23300P53

Property Data			Assessment Record						
Neighborhood 83 Avg-Good Location			Year	Land	Buildings	Exempt	Total		
Tree Growth Year 0			2011	63,350	204,673	0	268,023		
REVIEW 0			2012	63,350	204,673	0	268,023		
Building Permit 0			2013	63,350	204,673	0	268,023		
Zone/Land Use 23 Lake District			2014	63,350	204,673	8,500	259,523		
Secondary Zone			2015	63,400	204,700	9,000	259,100		
Topography 2 Rolling			2016	63,400	204,700	9,000	259,100		
1. Hill 4. Below St 7.			2017	63,400	204,700	13,500	254,600		
2. Rolling 5. Low 8.			2018	63,400	204,700	18,000	250,100		
3. Above St 6. Swampy 9.			2019	70,500	238,900	20,000	289,400		
Utilities 4 Filled Well/Point 6 Septic System			2020	70,500	238,900	20,000	289,400		
1. Public 4. Driv Well/Po 7. Cesspool			2021	70,500	238,900	25,000	284,400		
2. Water 5. Dug Well 8. Lake			2022	70,500	256,800	25,000	302,300		
3. Holding Ta 6. Septic 9. None			2023	70,500	290,900	25,000	336,400		
Street 1 Paved			Calc.	138,300	438,600	25,000	551,900		
1. Paved 4. Proposed			Land Data						
2. Semi Imp 5. R/O/W			Front Foot	Type	Effective		Influence		Influence Codes
3. Gravel 6. None 9. None					Frontage	Depth	Factor	Code	
GIS Map 7			11. Water (0-200)				%		1. Unimproved
Field Review 0			12. Water (201-400)				%		2. Excess Frtg
Sale Data			13. Water (401-800)				%		3. Topography
Sale Date 10/01/2005			14. Water (801-160)				%		4. Size/Shape
Price 332,500			15. Water (161-320)				%		5. Access
Sale Type			Square Foot				%		6. Restriction
1. Land 4. Mobile 7. COM			Square Feet				%		7. Open Space
2. L & B 5. Other 8.			16. Water (3201-6400)				%		8. Environmental
3. Building 6. Condo 9.			17. Water SF Amenities				%		9. Condo
Financing			18. Water View				%		Acres
1. Convent 4. Seller 7.			19. Water Influenc				%		30. Blueberry(1-20
2. FHA/VA 5. Private 8.			20. ShoreFront A				%		31. Blueberry(21 -
3. Assumed 6. Cash 9. Unknown			Fract. Acre				%		32. Crop Land
Validity			21. Base Lot	21	1.00	100	%	0	33. Pasture
1. Valid 4. Split 7. Multiple			22. Base Lot Vacan	24	1.35	100	%	0	34. Shorefront B
2. Related 5. Partial 8. Other			23. Base Lot Unpav				%		35. Shorefront C
3. Distress 6. Exempt 9. Estate			Acres				%		36. ANTENNA SITE
Verified			24. Acres to 10				%		37. Softwood TG
1. Buyer 4. Agent 7. Family			25. Acres 11-30				%		38. Mixed Wood TG
2. Seller 5. Pub Rec 8. Other			26. Acres 31-50				%		39. Hardwood TG
3. Lender 6. MLS 9.			27. Acres 51& over				%		40. Wasteland
			28. Acres 71 & Ove				%		41. Woodland
			29. Woods (41+)				%		42. Mobile Home Si
			Total Acreage		2.35				43. Camp Site

Inspection Witnessed By:

No./Date	Description	Date Insp.
X		

Notes:

Gray

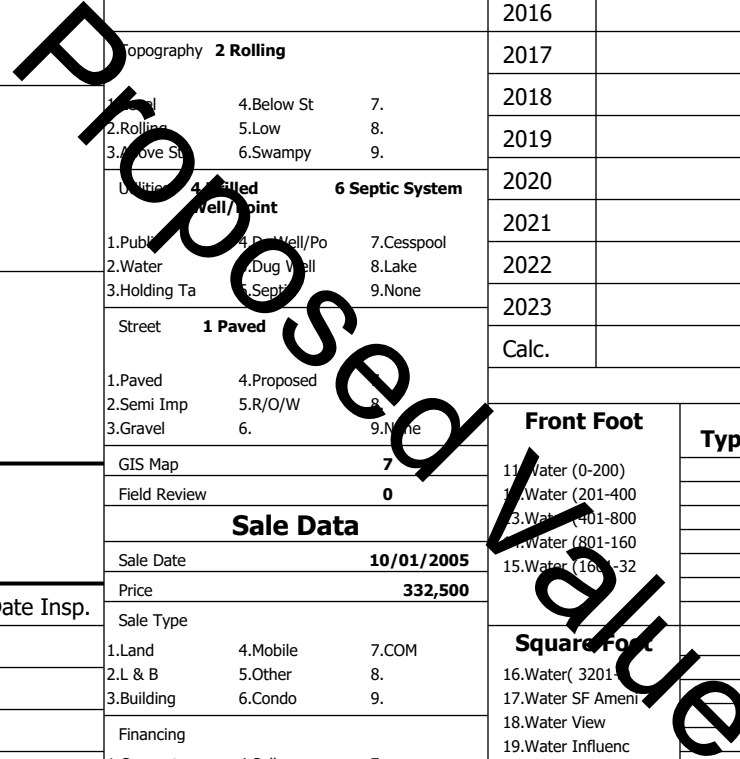

Gray

Map Lot 007-010-010-001

Account 259

Location 12 MAY MEADOW DR

Card 1 Of 1

8/05/2024

Building Style 10 Colonial	SF Bsmt Living 0	Layout 1 Typical
1.Conv. 5.Garrison 9.NE farm	Fin Bsmt Grade 0 0	1.Typical 4. 7.
2.Ranch 6.Split 10.Colonia	Secondary Heat 0	2.Inadeq 5. 8.
3.R Ranch/ 7.Contemp 11.Cottage	Heat Type 100% 1 Hot Water BB	3. 6. 9.
4.Cape 8.Log 12.Gambrel	1.HWBB 5.FWA 9.None	Attic 9 None
Dwelling Units 1	2.HWCI 6.Monitor 10.UNH2F	1.1/4 Fin 4.Full Fin 7.
Other Units 0	3.HWRF 7.Electric 11.Geother	2.1/2 Fin 5.FI/Stair 8.
Stories 2 Two Story	4.Steam 8.FI/Wall 12.Heat/Co	3.3/4 Fin 6. 9.None
1.1 4.1.5 7.	Cool Type 0% 9 None	Insulation 1 Full
2.2 5.1.75 8.	1.Central 4.W&C Air 7.	1.Full 4.Minimal 7.
3.3 6.2.5 9.	2.Evapor 5. 8.	2.Heavy 5. 8.
Exterior Walls 2 Vinyl/Aluminum	3.H Pump 6. 9.None	3.Capped 6. 9.None
1.Clapboard 5.Stucco 9.B & B	Kitchen Style 2 Typical	Unfinished % 0%
2.Vin/Al 6.Brick 10.Cemplan	1.Modern 4.Obsolete	Grade & Factor 3 Average 120%
3.Compos./ 7.Stone 11.Concret	2.Typical 5. 8.	1.E Grade 4.B Grade 7.SC Grade
4.Asbestos 8.Wood Shi 12.Wood Bo	3.Old Type 6. 9.None	2.C Grade 5.A Grade 8.
Roof Surface 1 Asphalt Shingles	Bath(s) Style 2 Typical Bath(s)	3.Grade 6.AA Grade 9.Same
1.Asphalt 4.Composit 7.Other	1.Modern 4.Obsolete 7.	SQFT (Footprint) 940
2.Slate 5.Wood 8.	2.Typical 5. 8.	Condition 4 Average
3.Metal 6.Roll Roo 9.	3.Old Type 6. 9.None	1.Poor 2.Avg 7.V G
SF Masonry Trim 0	# Rooms 7	2.Fair 3.Good 8.Exc
SOLAR VOLTAIC 0	# Bedrooms 3	3.Avg- 9.Same
OPEN-4- 0	# Full Baths 2	Phys. % Good 0%
Year Built 2006	# Half Baths 1	Funct. % Good 100%
Year Remodeled 0	# Addn Fixtures 1	Functional Code 9 None
Foundation 1 Concrete	# Fireplaces 1	1.Incomp 4.Delap 5.Playo
1.Concrete 4.Wood 7.		2.O-Built 5.Bsmt 8.Long term
2.C Block 5.Slab 8.		3.Damage 6.Style 9.None
3.Br/Stone 6.Piers 9.		Econ. % Good 100%
Basement 4 Full Basement		Economic Code None
1.1/4 Bmt 4.Full Bmt 7.		0.None 3.No Power 6.Obsoles
2.1/2 Bmt 5.Crwl 8.		1.Location 4.Generate 9.None
3.3/4 Bmt 6. 9.None		2.Encroach 5.Flood Pl 9.
Bsmt Gar # Cars 0		Entrance Code 0
Wet Basement 1 Dry Basement		1.Interior 4.Vacant 7.
1.Dry 4. 7.		2.Refusal 5.Estimate 8.
2.Damp 5. 8.		3.Informed 6. 9.
3.Wet 6. 9.		Information Code 0
		1.Owner 4.Agent 7.
		2.Relative 5.Estimate 8.
		3.Tenant 6.Other 9.

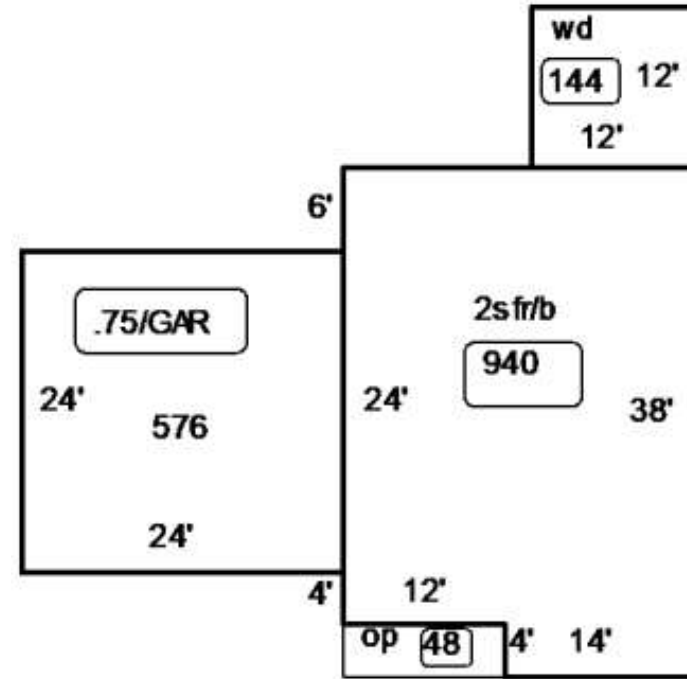

Date Inspected

Additions, Outbuildings & Improvements

Type	Year	Units	Grade	Cond	Phys.	Funct.	Sound Value	
68 Wood Deck	0	144	0 0	0	0	% 100 %		1.One Story Fram
21 Open Frame	0	48	0 0	0	0	% 100 %		2.Two Story Fram
23 Frame Garage	0	576	0 0	0	0	% 100 %		3.Three Story Fr
80 3/4 St/Garage	0	576	0 0	0	0	% 100 %		4.1 & 1/2 Story
						% %		5.1 & 3/4 Story
						% %		6.2 & 1/2 Story
						% %		21.Open Frame Por
						% %		22.Encl Frame Por
						% %		23.Frame Garage
						% %		24.Frame Shed
						% %		25.Frame Bay Wind
						% %		26.1SFr Overhang
						% %		27.Unfin Basement
						% %		28.Unfinished Att
						% %		29.Finished Attic