

KILLINGER, ANDREA J  
KILLINGER, MICHAEL B  
77 EGYPT ROAD  
GRAY ME 04039

B37601P130

Previous Owner  
HALL, STEVEN E  
77 EGYPT RD

GRAY ME 04039  
Sale Date: 12/21/2020

| Property Data    |                     |                | Assessment Record |         |           |        |         |
|------------------|---------------------|----------------|-------------------|---------|-----------|--------|---------|
| Neighborhood     | 82 Average Location |                | Year              | Land    | Buildings | Exempt | Total   |
| Tree Growth Year | 0                   |                | 2011              | 68,891  | 170,001   | 13,600 | 225,292 |
| REVIEW           | 0                   |                | 2012              | 68,929  | 170,001   | 0      | 238,930 |
| Building Permit  | 0                   |                | 2013              | 77,000  | 170,001   | 0      | 247,001 |
| Zone/Land Use    | 23 Lake District    |                | 2014              | 50,000  | 174,252   | 8,500  | 215,752 |
| Secondary Zone   |                     |                | 2015              | 50,000  | 174,300   | 9,000  | 215,300 |
|                  |                     |                | 2016              | 50,000  | 174,300   | 9,000  | 215,300 |
| Topography       | 2 Rolling           | 3 Above Street | 2017              | 50,000  | 174,300   | 13,500 | 210,800 |
|                  |                     |                | 2018              | 50,000  | 174,300   | 18,000 | 206,300 |
|                  |                     |                | 2019              | 79,500  | 219,800   | 20,000 | 279,300 |
|                  |                     |                | 2020              | 79,500  | 219,800   | 20,000 | 279,300 |
|                  |                     |                | 2021              | 79,500  | 228,800   | 25,000 | 283,300 |
|                  |                     |                | 2022              | 79,500  | 273,900   | 0      | 353,400 |
|                  |                     |                | 2023              | 79,500  | 293,700   | 0      | 373,200 |
|                  |                     |                | Calc.             | 144,000 | 452,600   | 25,000 | 571,600 |

| Land Data              |  | Front Foot  |       | Effective |      | Influence         |  | Influence Codes |
|------------------------|--|-------------|-------|-----------|------|-------------------|--|-----------------|
| Type                   |  | Frontage    | Depth | Factor    | Code |                   |  |                 |
| 1. Water (0-200)       |  |             |       | %         |      | 1.Unimproved      |  |                 |
| 2. Water (201-400)     |  |             |       | %         |      | 2.Excess Frtg     |  |                 |
| 3. Water (401-800)     |  |             |       | %         |      | 3.Topography      |  |                 |
| 4. Water (801-1600)    |  |             |       | %         |      | 4.Size/Shape      |  |                 |
| 5. Water (1601-3200)   |  |             |       | %         |      | 5.Access          |  |                 |
|                        |  |             |       | %         |      | 6.Restriction     |  |                 |
|                        |  |             |       | %         |      | 7.Open Space      |  |                 |
|                        |  |             |       | %         |      | 8.Environmental   |  |                 |
|                        |  |             |       | %         |      | 9.Condo           |  |                 |
| Square Foot            |  | Square Feet |       |           |      | Acres             |  |                 |
| 16. Water ( 3201-6400) |  |             |       | %         |      | 30.Blueberry(1-20 |  |                 |
| 17. Water SF Amenities |  |             |       | %         |      | 31.Blueberry(21 - |  |                 |
| 18. Water View         |  |             |       | %         |      | 32.Crop Land      |  |                 |
| 19. Water Influenc     |  |             |       | %         |      | 33.Pasture        |  |                 |
| 20. ShoreFront A       |  |             |       | %         |      | 34.Shorefront B   |  |                 |
|                        |  |             |       | %         |      | 35.Shorefront C   |  |                 |
|                        |  |             |       | %         |      | 36.ANTENNA SITE   |  |                 |
|                        |  |             |       | %         |      | 37.Softwood TG    |  |                 |
|                        |  |             |       | %         |      | 38.Mixed Wood TG  |  |                 |
|                        |  |             |       | %         |      | 39.Hardwood TG    |  |                 |
|                        |  |             |       | %         |      | 40.Wasteland      |  |                 |
|                        |  |             |       | %         |      | 41.Woodland       |  |                 |
|                        |  |             |       | %         |      | 42.Mobile Home Si |  |                 |
|                        |  |             |       | %         |      | 43.Camp Site      |  |                 |
|                        |  |             |       | %         |      | 44.Lot Improvemen |  |                 |
|                        |  |             |       | %         |      | 45.BA SF - Oce    |  |                 |
|                        |  |             |       | %         |      | 46.SP Meadow Cond |  |                 |
| <b>Total Acreage</b>   |  | 5.00        |       |           |      |                   |  |                 |

Inspection Witnessed By:

| X        | Date        |
|----------|-------------|
| No./Date | Description |
|          | Date Insp.  |

Notes:

Gray

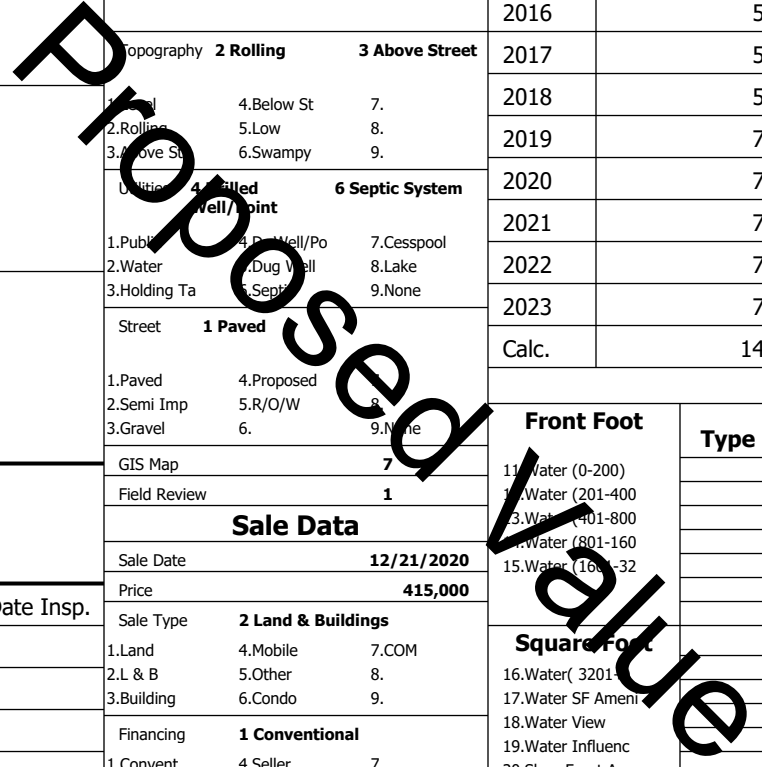

| Sale Data  |                    |            |
|------------|--------------------|------------|
| Sale Date  | 12/21/2020         |            |
| Price      | 415,000            |            |
| Sale Type  | 2 Land & Buildings |            |
| 1.Land     | 4.Mobile           | 7.COM      |
| 2.L & B    | 5.Other            | 8.         |
| 3.Building | 6.Condo            | 9.         |
| Financing  | 1 Conventional     |            |
| 1.Convent  | 4.Seller           | 7.         |
| 2.FHA/VA   | 5.Private          | 8.         |
| 3.Assumed  | 6.Cash             | 9.Unknown  |
| Validity   | 1 Arms Length Sale |            |
| 1.Valid    | 4.Split            | 7.Multiple |
| 2.Related  | 5.Partial          | 8.Other    |
| 3.Distress | 6.Exempt           | 9.Estate   |
| Verified   | 5 Public Record    |            |
| 1.Buyer    | 4.Agent            | 7.Family   |
| 2.Seller   | 5.Pub Rec          | 8.Other    |
| 3.Lender   | 6.MLS              | 9.         |

**Gray**

Map Lot 007-004-009-000

Account 82

Location 77 EGYPT RD

Card 1

Of 1

8/05/2024

|                                      |  |                                      |
|--------------------------------------|--|--------------------------------------|
| Building Style <b>8 Log Home</b>     | SF Bsmt Living <b>1320</b>             | Layout <b>1 Typical</b>              |
| 1.Conv. 5.Garrison 9.NE farm         | Fin Bsmt Grade <b>3 100</b>            | 1.Typical 4. 7.                      |
| 2.Ranch 6.Split 10.Colonia           | Secondary Heat <b>0</b>                | 2.Inadeq 5. 8.                       |
| 3.R Ranch/ 7.Contemp 11.Cottage      | Heat Type <b>100% 1 Hot Water BB</b>   | 3. 6. 9.                             |
| 4.Cape 8.Log 12.Gambrel              | 1.HWBB 5.FWA 9.None                    | Attic <b>9 None</b>                  |
| Dwelling Units <b>1</b>              | 2.HWCI 6.Monitor 10.UNH2F              | 1.1/4 Fin 4.Full Fin 7.              |
| Other Units <b>0</b>                 | 3.HWRF 7.Electric 11.Geother           | 2.1/2 Fin 5.FI/Stair 8.              |
| Stories <b>4 One &amp; 1/2 Story</b> | 4.Steam 8.FI/Wall 12.Heat/Co           | 3.3/4 Fin 6. 9.None                  |
| 1.1 4.1.5 7.                         | Cool Type <b>0% 9 None</b>             | Insulation <b>1 Full</b>             |
| 2.2 5.1.75 8.                        | 1.Central 4.W&C Air 7.                 | 1.Full 4.Minimal 7.                  |
| 3.3 6.2.5 9.                         | 2.Evapor 5. 8.                         | 2.Heavy 5. 8.                        |
| Exterior Walls <b>13 Log</b>         | 3.H Pump 6. 9.None                     | 3.Capped 6. 9.None                   |
| 1.Clapboar 5.Stucco 9.B & B          | Kitchen Style <b>2 Typical</b>         | Unfinished % <b>0%</b>               |
| 2.Vin/Al 6.Brick 10.Cemplan          | 1.Modern 4.Obsolete                    | Grade & Factor <b>3 Average 110%</b> |
| 3.Compos./ 7.Stone 11.Concret        | 2.Typical 5. 8.                        | 1.E Grade 4.B Grade 7.SC Grade       |
| 4.Asbestos 8.Wood Shi 12.Wood Bo     | 3.Old Type 6. 9.None                   | 2.C Grade 5.A Grade 8.               |
| Roof Surface <b>3 Metal</b>          | Bath(s) Style <b>2 Typical Bath(s)</b> | 3.Grade 6.AA Grade 9.Same            |
| 1.Asphalt 4.Composit 7.Other         | 1.Modern 4.Obsolete 7.                 | SQFT (Footprint) <b>960</b>          |
| 2.Slate 5.Wood 8.                    | 2.Typical 5. 8.                        | Foundation <b>4 Average</b>          |
| 3.Metal 6.Roll Roo 9.                | 3.Old Type 6. 9.None                   | 1.Poor 2.Avg 7.V G                   |
| SF Masonry Trim <b>0</b>             | # Rooms <b>7</b>                       | 2.Fair 3.Avg 8.Exc                   |
| SOLAR VOLTAIC <b>0</b>               | # Bedrooms <b>3</b>                    | 3.Avg- 9.Good 9.Same                 |
| OPEN-4- <b>0</b>                     | # Full Baths <b>3</b>                  | Phys. % Good <b>0%</b>               |
| Year Built <b>1976</b>               | # Half Baths <b>0</b>                  | Funct. % Good <b>100%</b>            |
| Year Remodeled <b>0</b>              | # Addn Fixtures <b>0</b>               | Functional Code <b>9 None</b>        |
| Foundation <b>1 Concrete</b>         | # Fireplaces <b>1</b>                  | 1.Incomp 4.Delap 5.Playo             |
| 1.Concrete 4.Wood 7.                 |  | 2.O-Built 5.Bsmt 6.Long term         |
| 2.C Block 5.Slab 8.                  |  | 3.Damage 6.Style 9.None              |
| 3.Br/Stone 6.Piers 9.                |  | Econ. % Good <b>100%</b>             |
| Basement <b>4 Full Basement</b>      |  | Economic Code <b>None</b>            |
| 1.1/4 Bmt 4.Full Bmt 7.              |  | 0.None 3.No Power 6.Obsolete         |
| 2.1/2 Bmt 5.CrwI 8.                  |  | 1.Location 4.Generate 9.None         |
| 3.3/4 Bmt 6. 9.None                  |  | 2.Encroach 5.Flood Pl 9.             |
| Bsmt Gar # Cars <b>0</b>             |  | Entrance Code <b>5 Estimated</b>     |
| Wet Basement <b>1 Dry Basement</b>   |  | 1.Interior 4.Vacant 7.               |
| 1.Dry 4. 7.                          |  | 2.Refusal 5.Estimate 8.              |
| 2.Damp 5. 8.                         |  | 3.Informed 6. 9.                     |
| 3.Wet 6. 9.                          |  | Information Code <b>0</b>            |
|                                      |  | 1.Owner 4.Agent 7.                   |
|                                      |  | 2.Relative 5.Estimate 8.             |
|                                      |  | 3.Tenant 6.Other 9.                  |

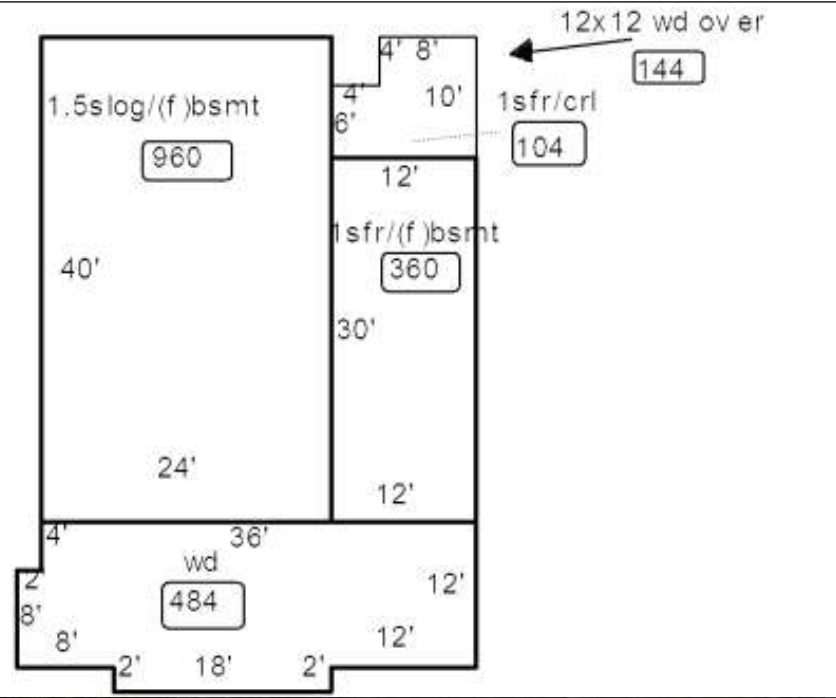

Date Inspected

**Additions, Outbuildings & Improvements**

| Type                | Year | Units | Grade | Cond | Phys. | Funct.  | Sound Value |
|---------------------|------|-------|-------|------|-------|---------|-------------|
| 11 1 Story/Basement | 1976 | 360   | 0 0   | 0    | 0     | % 100 % |             |
| 68 Wood Deck        | 1976 | 484   | 0 0   | 0    | 0     | % 100 % |             |
| 68 Wood Deck        | 2015 | 144   | 0 0   | 0    | 0     | % 100 % |             |
| 59 2 St. Barn       | 0    | 1620  | 3 100 | 5    | 0     | % 100 % |             |
| 86 Gazebo           | 0    | 144   | 3 100 | 4    | 0     | % 100 % |             |
| 1 One Story Frame   | 1976 | 104   | 0 0   | 0    | 0     | % 100 % |             |
| 24 Frame Shed       | 1976 | 96    | 2 100 | 4    | 0     | % 100 % |             |
| 24 Frame Shed       | 1976 | 96    | 2 100 | 3    | 0     | % 100 % |             |
| 24 Frame Shed       | 1976 | 96    | 2 100 | 3    | 0     | % 100 % |             |

- 1.One Story Fram
- 2.Two Story Fram
- 3.Three Story Fr
- 4.1 & 1/2 Story
- 5.1 & 3/4 Story
- 6.2 & 1/2 Story
- 21.Open Frame Por
- 22.Encl Frame Por
- 23.Frame Garage
- 24.Frame Shed
- 25.Frame Bay Wind
- 26.1SFr Overhang
- 27.Unfin Basement
- 28.Unfinished Att
- 29.Finished Attic