

EKSTER, MICHAEL L
EKSTER, PATRICIA C
111 BLUEBERRY LANE
GRAY ME 04039

B28507P56

Property Data			Assessment Record						
Neighborhood 83 Avg-Good Location			Year	Land	Buildings	Exempt	Total		
Tree Growth Year 0			2011	56,500	175,488	0	231,988		
REVIEW 0			2012	56,500	175,488	0	231,988		
Building Permit 0			2013	56,500	175,488	8,500	223,488		
Zone/Land Use 11 Rural Residential & Agri			2014	56,500	163,585	8,500	211,585		
Secondary Zone			2015	56,500	168,200	9,000	215,700		
Topography 1 Level			2016	56,500	168,200	9,000	215,700		
1. Hill 4. Below St 7.			2017	56,500	171,000	13,500	214,000		
2. Rolling 5. Low 8.			2018	56,500	171,000	18,000	209,500		
3. Above St 6. Swampy 9.			2019	65,200	200,300	20,000	245,500		
Utilities 4. Filled Well/Point 6 Septic System			2020	65,200	200,300	20,000	245,500		
1. Public 4. Dug Well/Po 7. Cesspool			2021	65,200	200,300	25,000	240,500		
2. Water 8. Lake			2022	65,200	217,400	25,000	257,600		
3. Holding Ta 9. None			2023	65,200	246,100	25,000	286,300		
Street 1 Paved			Calc.	137,800	372,900	25,000	485,700		
1. Paved 4. Proposed			Land Data						
2. Semi Imp 5. R/O/W			Front Foot	Type	Effective		Influence		Influence Codes
3. Gravel 6. None					Frontage	Depth	Factor	Code	
GIS Map 5			11. Water (0-200)				%		1. Unimproved
Field Review 1			12. Water (201-400)				%		2. Excess Frtg
Sale Data			13. Water (401-800)				%		3. Topography
Sale Date 1/28/2011			14. Water (801-160)				%		4. Size/Shape
Price 227,500			15. Water (161-320)				%		5. Access
Sale Type			Square Foot				%		6. Restriction
1. Land 4. Mobile 7.COM			Square Feet				%		7. Open Space
2. L & B 5. Other 8.			16. Water (3201-6400)				%		8. Environmental
3. Building 6. Condo 9.			17. Water SF Amenities				%		9. Condo
Financing			18. Water View				%		Acres
1. Convent 4. Seller 7.			19. Water Influenc				%		30. Blueberry(1-20
2. FHA/VA 5. Private 8.			20. ShoreFront A				%		31. Blueberry(21 -
3. Assumed 6. Cash 9.Unknown			Fract. Acre				%		32. Crop Land
Validity			21. Base Lot	21	1.84	100	%	0	33. Pasture
1. Valid 4. Split 7. Multiple			22. Base Lot Vacan	24	0.05	100	%	0	34. Shorefront B
2. Related 5. Partial 8. Other			23. Base Lot Unpav				%		35. Shorefront C
3. Distress 6. Exempt 9. Estate			Acres				%		36. ANTENNA SITE
Verified			24. Acres to 10				%		37. Softwood TG
1. Buyer 4. Agent 7. Family			25. Acres 11-30				%		38. Mixed Wood TG
2. Seller 5. Pub Rec 8. Other			26. Acres 31-50				%		39. Hardwood TG
3. Lender 6. MLS 9.			27. Acres 51& over				%		40. Wasteland
			28. Acres 71 & Ove				%		41. Woodland
			29. Woods (41+)				%		42. Mobile Home Si
			Total Acreage		1.89				

Inspection Witnessed By:

No./Date	Description	Date Insp.
X		

Notes:
5/24- DR FIELD REVIEW

Gray

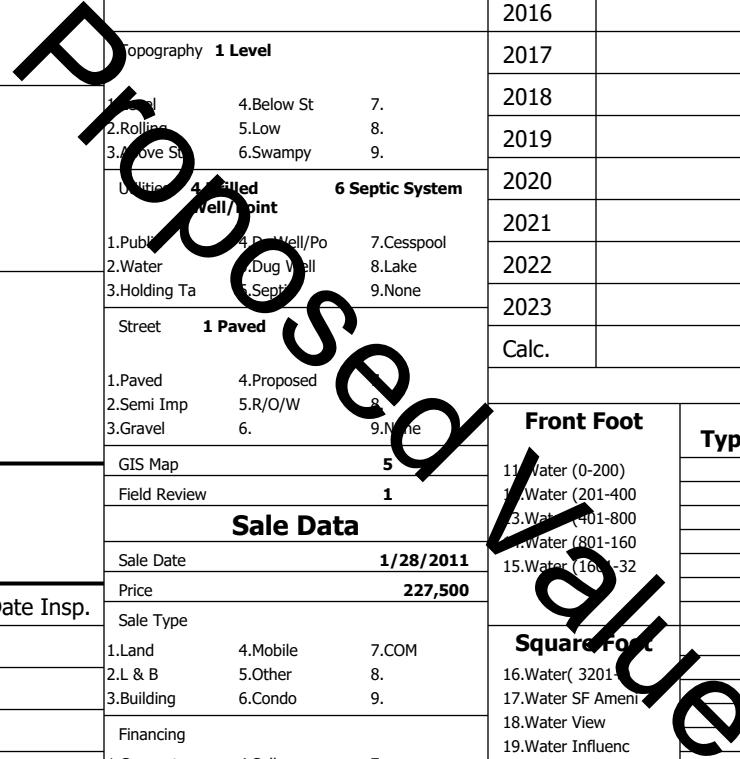

Gray

Map Lot 005-016-079-000

Account 728

Location 111 BLUEBERRY LN

Card 1

Of 1

8/05/2024

Building Style 4 Cape Cod	SF Bsmt Living 0	Layout 1 Typical
1.Conv. 5.Garrison 9.NE farm	Fin Bsmt Grade 0 0	1.Typical 4. 7.
2.Ranch 6.Split 10.Colonia	Secondary Heat 0	2.Inadeq 5. 8.
3.R Ranch/ 7.Contemp 11.Cottage	Heat Type 100% 1 Hot Water BB	3. 6. 9.
4.Cape 8.Log 12.Gambrel	1.HWBB 5.FWA 9.None	Attic 9 None
Dwelling Units 1	2.HWCI 6.Monitor 10.UNH2F	1.1/4 Fin 4.Full Fin 7.
Other Units 0	3.HWRF 7.Electric 11.Geother	2.1/2 Fin 5.FI/Stair 8.
Stories 5 One & 3/4 Story	4.Steam 8.FI/Wall 12.Heat/Co	3.3/4 Fin 6. 9.None
1.1 4.1.5 7.	Cool Type 0% 9 None	Insulation 1 Full
2.2 5.1.75 8.	1.Central 4.W&C Air 7.	1.Full 4.Minimal 7.
3.3 6.2.5 9.	2.Evapor 5. 8.	2.Heavy 5. 8.
Exterior Walls 2 Vinyl/Aluminum	3.H Pump 6. 9.None	3.Capped 6. 9.None
1.Clapboar 5.Stucco 9.B & B	Kitchen Style 2 Typical	Unfinished % 0%
2.Vin/Al 6.Brick 10.Cemplan	1.Modern 4.Obsolete	Grade & Factor 3 Average 110%
3.Compos./ 7.Stone 11.Concret	2.Typical 5. 8.	1.E Grade 4.B Grade 7.SC Grade
4.Asbestos 8.Wood Shi 12.Wood Bo	3.Old Type 6. 9.None	2.O Grade 5.A Grade 8.
Roof Surface 1 Asphalt Shingles	Bath(s) Style 2 Typical Bath(s)	3.O Grade 6.AA Grade 9.Same
1.Asphalt 4.Composit 7.Other	1.Modern 4.Obsolete 7.	SQFT (Footprint) 936
2.Slate 5.Wood 8.	2.Typical 5. 8.	Foundation 4 Average
3.Metal 6.Roll Roo 9.	3.Old Type 6. 9.None	1.Poor 2.Avg 7.V G
SF Masonry Trim 0	# Rooms 6	2.Fair 3.Avg 8.Exc
SOLAR VOLTAIC 0	# Bedrooms 3	3.Avg- 4.Good 9.Same
OPEN-4- 0	# Full Baths 1	Phys. % Good 0%
Year Built 1998	# Half Baths 1	Funct. % Good 100%
Year Remodeled 0	# Addn Fixtures 0	Functional Code 9 None
Foundation 1 Concrete	# Fireplaces 0	1.Incomp 4.Delap 5.Playo
1.Concrete 4.Wood 7.		2.O-Built 5.Bsmt 6.Long term
2.C Block 5.Slab 8.		3.Damage 6.Style None
3.Br/Stone 6.Piers 9.		Econ. % Good 100%
Basement 4 Full Basement		Economic Code None
1.1/4 Bmt 4.Full Bmt 7.		0.None 3.No Power 6.Obsolete
2.1/2 Bmt 5.Crwl 8.		1.Location 4.Generate 9.None
3.3/4 Bmt 6. 9.None		2.Encroach 5.Flood Pl 9.
Bsmt Gar # Cars 0		Entrance Code 5 Estimated
Wet Basement 1 Dry Basement		1.Interior 4.Vacant 7.
1.Dry 4. 7.		2.Refusal 5.Estimate 8.
2.Damp 5. 8.		3.Informed 6. 9.
3.Wet 6. 9.		Information Code 5 Estimate
		1.Owner 4.Agent 7.
		2.Relative 5.Estimate 8.
		3.Tenant 6.Other 9.

Date Inspected 5/16/2024

Additions, Outbuildings & Improvements

Type	Year	Units	Grade	Cond	Phys.	Funct.	Sound Value
68 Wood Deck	0	240	0 0	0	0 %	100 %	
62 Patio	0	220	3 100	4	0 %	100 %	
24 Frame Shed	0	192	3 100	4	0 %	100 %	
68 Wood Deck	2015	70	3 100	5	0 %	80 %	
23 Frame Garage	0	616	0 0	0	0 %	100 %	
79 1/2 St/Garage	0	616	0 0	0	0 %	100 %	
					%	%	
					%	%	
					%	%	
					%	%	

